



1 Clifford Parade Barwon Heads VIC

4 🛏 2 🚿 1 🚗

The Feel:

Located in one of Barwon Heads' most tightly held inner-village pockets, this substantial 617sqm (approx.) allotment presents a rare opportunity to secure premium land with significant future potential. Just steps from Hitchcock Avenue and moments from the river, the true value lies in the location, scale and flexibility of the site. The property is zoned Commercial 1 and has a number of future uses for both residential and commercial development.

The existing four-bedroom home remains comfortable and functional, offering the option to live in or lease out while planning a renovation, extension or redevelopment (STCA). With a generous backyard and excellent privacy, this is a property that rewards vision - whether creating a standout new residence or simply holding a blue-chip village asset with long-term appeal.

The Facts:

-Highly prized inner-village location just steps from

[For full version visit the website](https://www.bellarineproperty.com.au)

Type : House
Price : \$1,750,000-\$1,850,000
Land Size : 617 sqm
View : <https://www.bellarineproperty.com.au/8691181>



Levi Turner
03 5254 3100



Peta Walter
03 5254 3100

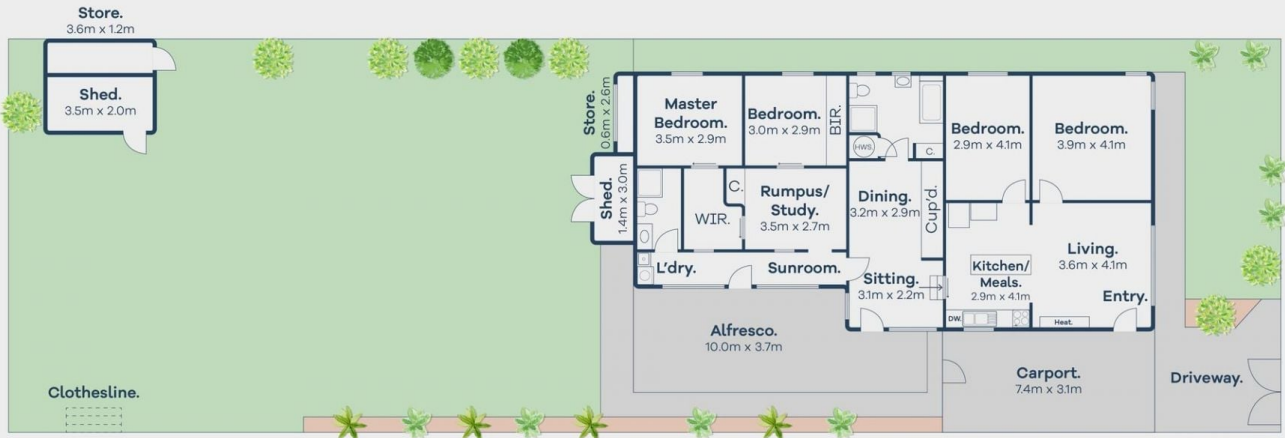

1 Clifford Parade, Barwon Heads.

4 Bed | 2 Bath | 1 Car | 617sqm

bellarine **b** property