



28 Crimea Street Drysdale VIC

4 3 6

The Feel:

Pairing a spectacular custom design with storied materials sourced from across the country, this family residence - complete with a separate guest house and indulgent poolside entertaining - stands as one of the region's most rarefied expressions of character and liveability. Set on 2.26 acres (approx.) beyond a commanding limestone façade, the dual-level residence unfolds through a series of expansive living spaces, each artfully composed with warm, rustic detailing. Lifestyle is prioritised at every turn, from the north-facing entertainer's terrace to the self-cleaning pool and built-in spa, while the self-contained guest house offers exceptional flexibility for visitors or multi-generational living. Peaceful, private, and teeming with birdlife, this is inner-village living at its finest - mere moments from Lake Lorne Reserve, Recreation Reserve, the local school precinct, and the vibrant heart of Drysdale township.

Type : House
Price : \$ 1,800,000
Land Size : 9149 sqm
View : <https://www.bellarineproperty.com.au/8643603>



Lee Martin
03 5297 3888



Andrew Kibbis
03 5254 3100

The Facts:

-One of the region's most distinctive lifestyle estates,

[For full version visit the website](https://www.bellarineproperty.com.au)

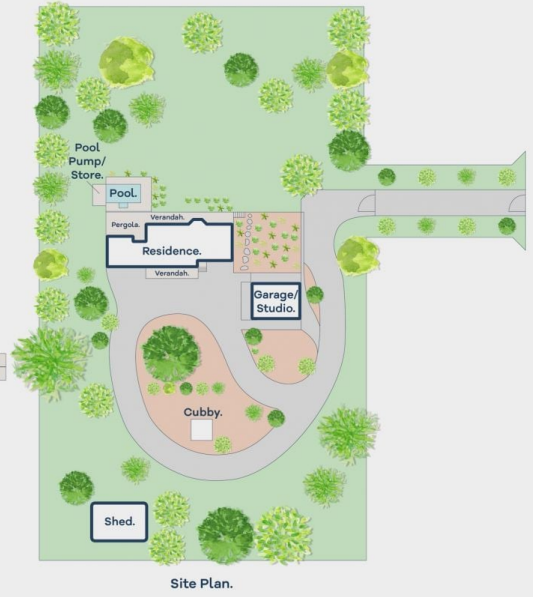

28 Crimea Street, Drysdale.

4 Bed | 3 Bath | 2 Car | 9148sqm

bellarine **b** property