



23 Horwood Drive Breamlea VIC

2 🛏 1 🚿 2 🚗

The Feel:

Perched high above the wetlands and winding river of Breamlea, this utterly unique two-bedroom, one-bathroom residence delivers unmatched panoramic views and true seclusion within a tightly held coastal hamlet. The home is cleverly designed over two levels, maximising its elevated position to capture sweeping vistas from every room?from sunrise over Port Phillip Heads to sunsets over an expansive open horizon. Surrounded by established gardens and accessed via front and rear winding private stairways, the residence unfolds like a well-kept secret. A large entertaining deck and upper balcony stretch the living zones out into nature, while indoors, timber-lined ceilings, cosy living, and exposed beams create an atmosphere of warmth and charm. Whether you're gazing out over the tidal rhythms of Thompsons Creek or watching ships pass the lighthouse, this home connects you deeply to land, sky, and sea.

The Facts:

-Elevated two-bedroom, one-bathroom home with separate

[For full version visit the website](https://www.bellarineproperty.com.au/85062)

Type : House
Price : \$ 1,325,000
Land Size : 765 sqm
View : <https://www.bellarineproperty.com.au/85062>
19



Peta Walter
03 5254 3100



Levi Turner
03 5254 3100



Garage.
5.3m x 5.3m

(Not In Position).



Shed.
3.0m x 1.8m

(Not In Position).

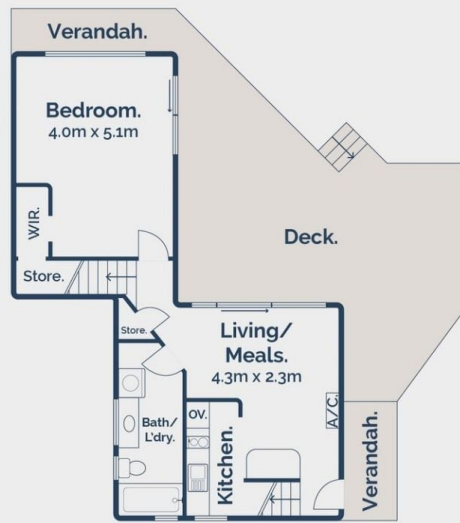

Ground Floor.



First Floor.



Site Plan.



23 Horwood Drive, Breamlea