



## 14-16 Anstead Avenue Curlewis VIC

4 2 2

### The Feel:

Defined by its light-filled interiors, impressive free-flowing proportions, and relaxed coastal aesthetic, this contemporary home reinforces its family-friendly credentials with a prime park-side location within the established Curlewis Park Estate. With 4 generous bedrooms and a choice of versatile living areas, the home's single-level layout has been designed to provide an easy-care environment where space, convenience and privacy all go hand-in-hand. Sitting on a 489sqm (approx.) allotment with a sun-drenched rear yard, this superb package is ready for growing families to move in and enjoy its wonderful location that's just moments from all key lifestyle and practical amenities.

### The Facts:

- Fresh & contemporary home is a perfect option for growing families & upsizers
- Delivering excellent lifestyle appeal with its generous accommodation, modern finishes & sunny outdoors
- Superb location overlooking the open green space & playground of Dunn Reserve
- Single level layout cleverly designed to maximise space &

**Price** : \$620,000-\$640,000

**Land Size** : 489 sqm

**View** : <https://www.bellarineproperty.com.au/7969038>



**Lee Martin**  
03 5297 3888



**Andrew Kibbis**  
03 5254 3100

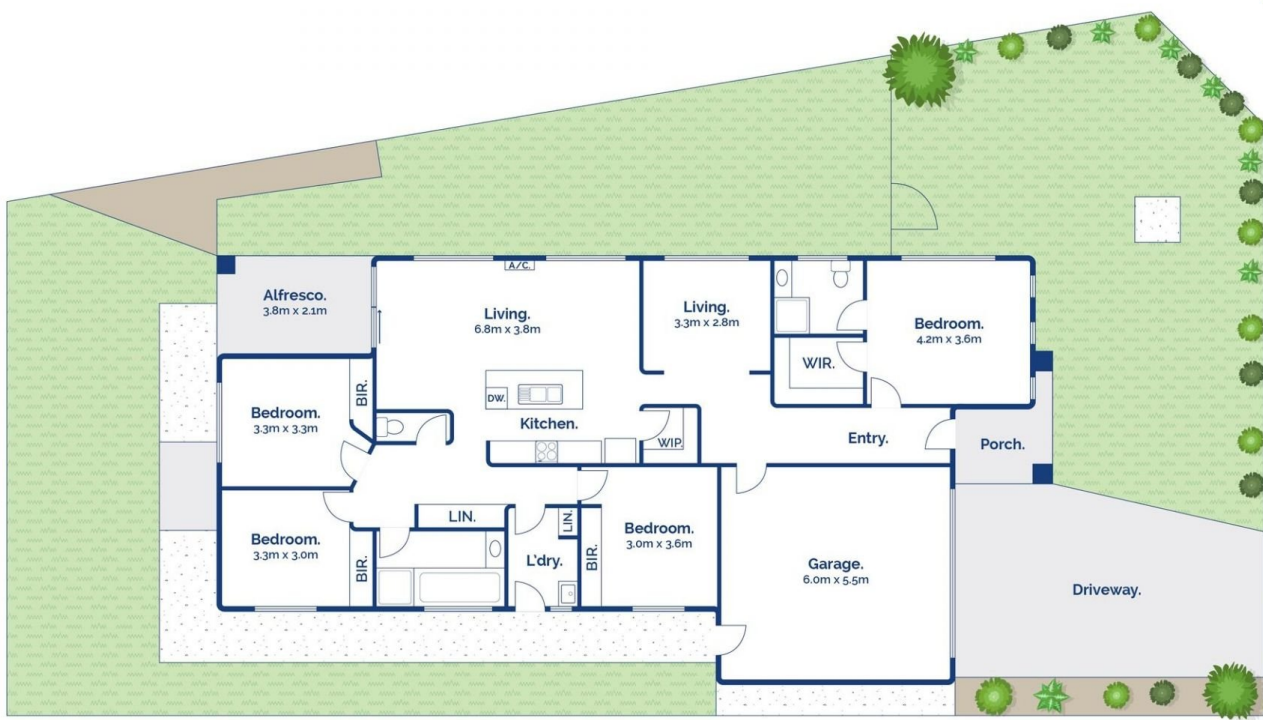

# 14-16 Anstead Avenue, Curlewis

**bellarine** property  
rentals. commercial. sales. projects.

Whilst [bwr.com.au](http://bwr.com.au) has made every attempt to ensure the accuracy of the floor plan contained here, measurements are approximate and no responsibility is taken for any error, omission, or mis-statement. This plan is for illustrative purposes only.