



14-15 Warrenbeen Court Barwon Heads VIC

3 2 2

The Feel:

Celebrating the natural elements and raw beauty of its magnificent coastal surrounds, this tranquil family hideaway graces a superb 3877sqm (approx.) allotment, wonderfully secluded amid stunning native Moonah woodland. Showcasing a tri-level zoned layout that accommodates effortless family living, 'Moonavale' comprises 3 bedrooms, 2 generous living zones and a choice of alfresco decks overlooking the verdant treetop landscape. Utterly private, yet within walking distance of the village centre, this wonderfully inviting home offers the coveted combination of peace, serenity, and complete lifestyle convenience.

The Facts:

- A multi-level hideaway on 3877sqm (approx.) of tranquil Moonah woodland
- Be instantly immersed in the soothing ambience of this quiet & exclusive setting
- Wonderfully removed from the hustle & bustle, yet offering easy access to Barwon Heads' best assets
- Tri-level layout is highlighted by expansive living zones & effortless outdoor connection
- On the top floor, an open plan kitchen, living & dining area

Price : \$3,200,000-\$3,500,000
Land Size : 3877 sqm
View : <https://www.bellarineproperty.com.au/7877103>



Levi Turner
03 5254 3100



Peta Walter
03 5254 3100

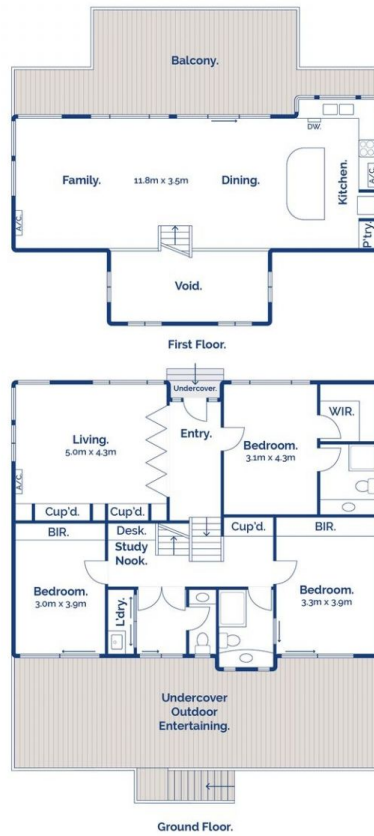

Site Plan.

3 2 2

14-15 Warrenbeen Court, Barwon Heads

bellarine **b** **property**
rentals. commercial. sales. projects.

Whilst bwrm.com.au has made every attempt to ensure the accuracy of the floor plan contained here, measurements are approximate and no responsibility is taken for any error, omission, or mis-statement. This plan is for illustrative purposes only.