



168 The Esplanade Indented Head VIC

4 🏠 2 🚿 2 🚗

The Feel:

Few homes enjoy such a privileged position as this delightful mid-century beach house, where a front-row seat to the glassy waters of the bay forms the backdrop to daily life. Inviting serene seaside getaways, this stylishly updated home radiates all the charm of its era with beautiful hardwood flooring, pitched ceilings and large picture windows that harness the stunning views that stretch across the bay to the Melbourne city skyline. Spilling across two bright and airy levels, it boasts four view-swept bedrooms, two fully renovated bathrooms, and a choice of living spaces, making it the perfect choice for permanent coastal lifestyle living or idyllic weekend getaways.

The Facts:

- A delightful mid-century beach house backdropped by uninterrupted blue-water views
- North-east orientation takes in picturesque sunrises while stretching to the Melbourne skyline
- Watch all the on-water activity from your serene vantage point, including the Spirit of Tasmania making its way

[For full version visit the website](https://www.bellarineproperty.com.au)

Type : House
Land Size : 613 sqm
View : <https://www.bellarineproperty.com.au/7855387>



Lee Martin
03 5297 3888



Andrew Kibbis
03 5254 3100

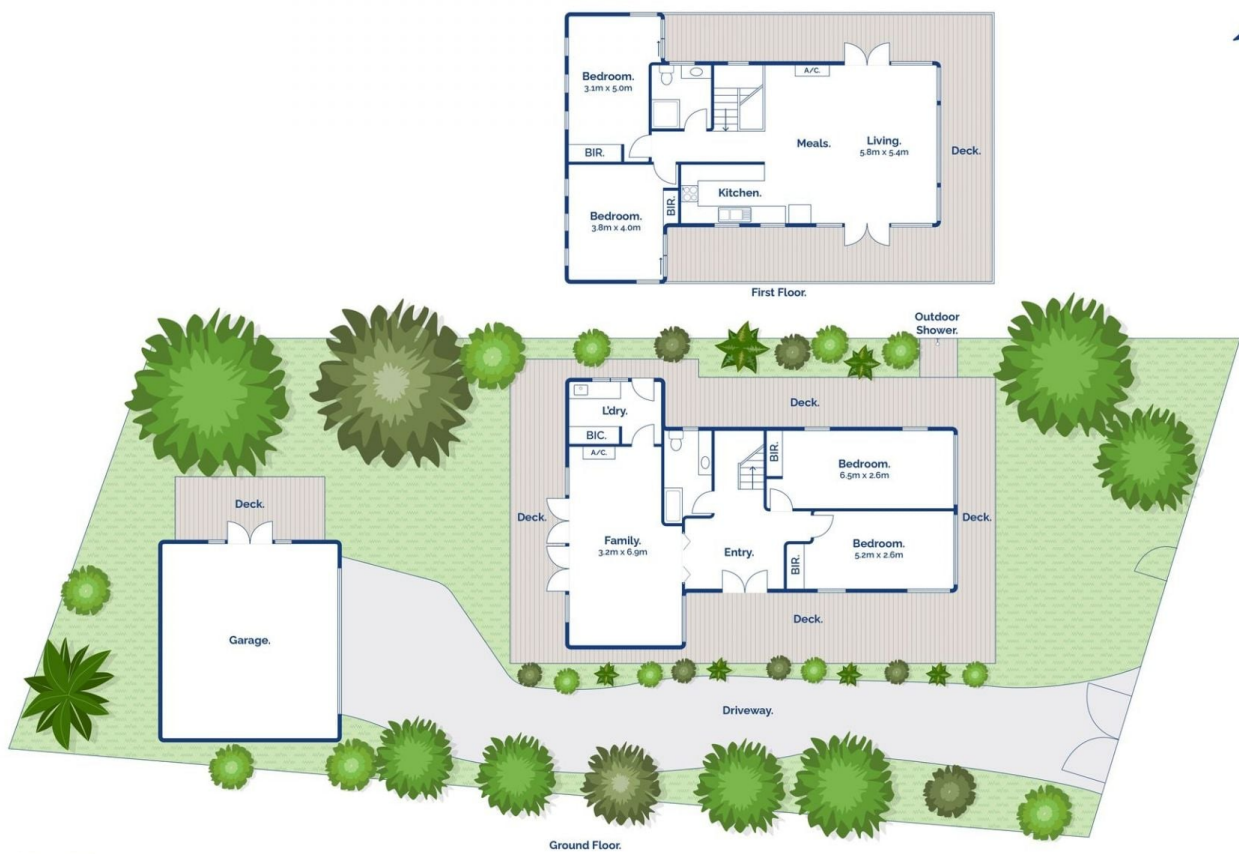

4 2 2

168 The Esplanade, Indented Head

bellarine property
rentals. commercial. sales. projects.

Whilst bwrn.com.au has made every attempt to ensure the accuracy of the floor plan contained here, measurements are approximate and no responsibility is taken for any error, omission, or mis-statement. This plan is for illustrative purposes only.