



23 Cresta Street Leopold VIC

3 3 6

The Feel:

As if lifted straight from the pages of a magazine, this immaculate custom designed and built home sets a new standard of contemporary living in the ultra-convenient heart of Leopold. An impressive combination of hand-picked finishes, natural materials and passive design principles blur the lines between art and architecture, while light-filled living spaces and a tranquil garden setting unite aesthetic beauty with premium lifestyle amenities. Embracing a brilliant north aspect, this wonderfully private residence is superbly situated between the Geelong CBD and all the coastal delights of the Bellarine Peninsula, further enhancing its outstanding lifestyle appeal.

The Facts:

- One-of-a-kind family residence, designed & built to an exacting standard
- Hand-picked finishes & thoughtful use of space are perfectly presented over 2 light-filled levels
- Meticulous attention to detail is evident from the outset as a hand-made front gate creates a welcoming first impression
- Corten clad exterior integrates seamlessly with spotted

Price : \$ 1,600,000
Land Size : 758 sqm
View : <https://www.bellarineproperty.com.au/77785>
 43



Lee Martin
 03 5297 3888



Andrew Kibbis
 03 5254 3100

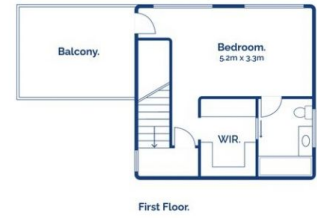

3 3 6

23 Cresta Street, Leopold

bellarine property
rentals. commercial. sales. projects.

Whilst bwr.com.au has made every attempt to ensure the accuracy of the floor plan contained here, measurements are approximate and no responsibility is taken for any error, omission, or mis-statement. This plan is for illustrative purposes only.