



1/1 Cottesloe Drive Barwon Heads VIC

3 2 1

The Feel:

Presenting an exciting opportunity to secure a property in one of Barwon Heads' most desirable locations. This double storey Cottesloe Drive residence maximises its north aspect, with high raked ceilings that flood the interiors in natural light. Outdoor entertaining takes place on the large front deck, while dual living rooms and 3-4 bedrooms give everyone room to relax, work and play. Incredible proximity to the Village Park playground and skate park is sure to excite, with recreational facilities, school, shops and cafés all within walking distance.

The Facts:

- Attractive street appeal with a trio of gum trees in desirable Cottesloe Drive
- Cool, modern, architectural home with panelled exteriors, earthy palette & timber accents
- Walk to the Village Park, beach, shops, early childhood centre & primary school
- Spacious home set to the rear of 320sqm (approx) block, takes full advantage of north living
- Soaring raked ceiling amplifies the sense of space, inviting the natural light inside

Price : \$ 1,365,000
Land Size : 320 sqm
View : <https://www.bellarineproperty.com.au/7144737>



Levi Turner
03 5254 3100



Peta Walter
03 5254 3100

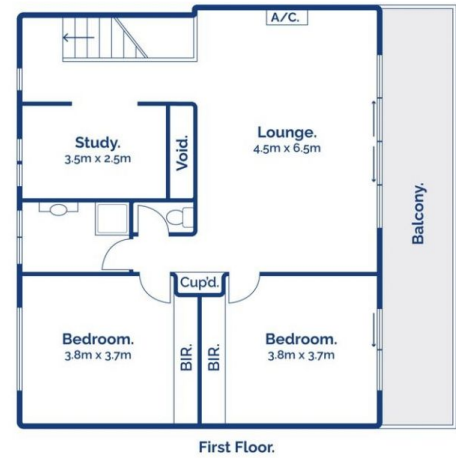

3 2 1

1/1 Cottesloe Drive, Barwon Heads

bellarine **b** property
Rentals | Commercial | Sales | Projects

Whilst bwrm.com.au has made every attempt to ensure the accuracy of the floor plan contained here, measurements are approximate and no responsibility is taken for any error, omission, or mis-statement. This plan is for illustrative purposes only.