



5 Graham Lane Connewarre VIC

3 2 4

The Feel:

Whether you are looking for a country lifestyle, the convenience of being 5 minutes to the coast, or 8 minutes to the Armstrong Creek shopping centre, this property has it all! A must see for those seeking peace and quietude, this privately situated property occupies 3.75 acres (approx) with room to indulge your passion for horses, animals or farming. Designed to maximise the north-facing position and views over the paddocks, the 3BR home is an entertainer's haven, with an undercover pergola adjoining the decked above ground pool. Substantial shedding, productive gardens, 3 large paddocks and animal enclosures provide a ready start to rural life...

The Facts:

- Dual frontage homestead set across private & peaceful 3.75 acres (approx.)
- Zoned Low Density Residential, town water connected; manageable size land for anyone looking for space
- Long driveway leads to home & garaging, set back from the road, with privacy of extensive planting
- Ideal opportunity for more space for the family, or to experience the joy of semi-rural living!

Price : \$ 1,641,500
Land Size : 3.75 Acres
View : <https://www.bellarineproperty.com.au/6773906>



Peta Walter
03 5254 3100



Levi Turner
03 5254 3100

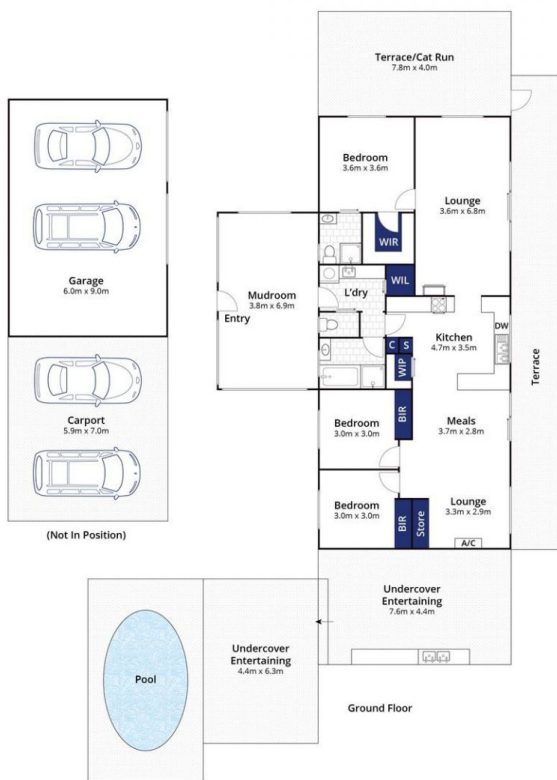

Site Plan

Whilst bwr.com.au has made every attempt to ensure the accuracy of the floor plan contained here, measurements are approximate and no responsibility is taken for any error, omission, or mis-statement. This plan is for illustrative purposes only.

5 Graham Lane, Connewarre