



17 Andale Avenue Curlewis VIC

4 2 2

The Feel:

Wonderfully designed to accommodate your growing family with ease, this stylish up-scaled property is move-in ready and ideally situated to take advantage of the best of the Bellarine. The modern contemporary interior is complemented by plenty of natural light; with multiple outdoor entertaining zones completing this picture perfect property.

The Facts:

- OP kitchen, dining and living zone with superior outdoor connection
- Stylish hostess kitchen with high-end Ilve appliances and large butler's pantry
- The living zone conveniently opens up to the sunny north-facing backyard
- Heightened ceilings, timber floors and feature pendant lighting
- Second sitting room doubles as perfect work from home space
- Luxurious master suite with well fitted WIR and ensuite

Type : House
Land Size : 550 sqm
View : <https://www.bellarineproperty.com.au/65487>
35



Lee Martin
03 5297 3888

[For full version visit the website](https://www.bellarineproperty.com.au)

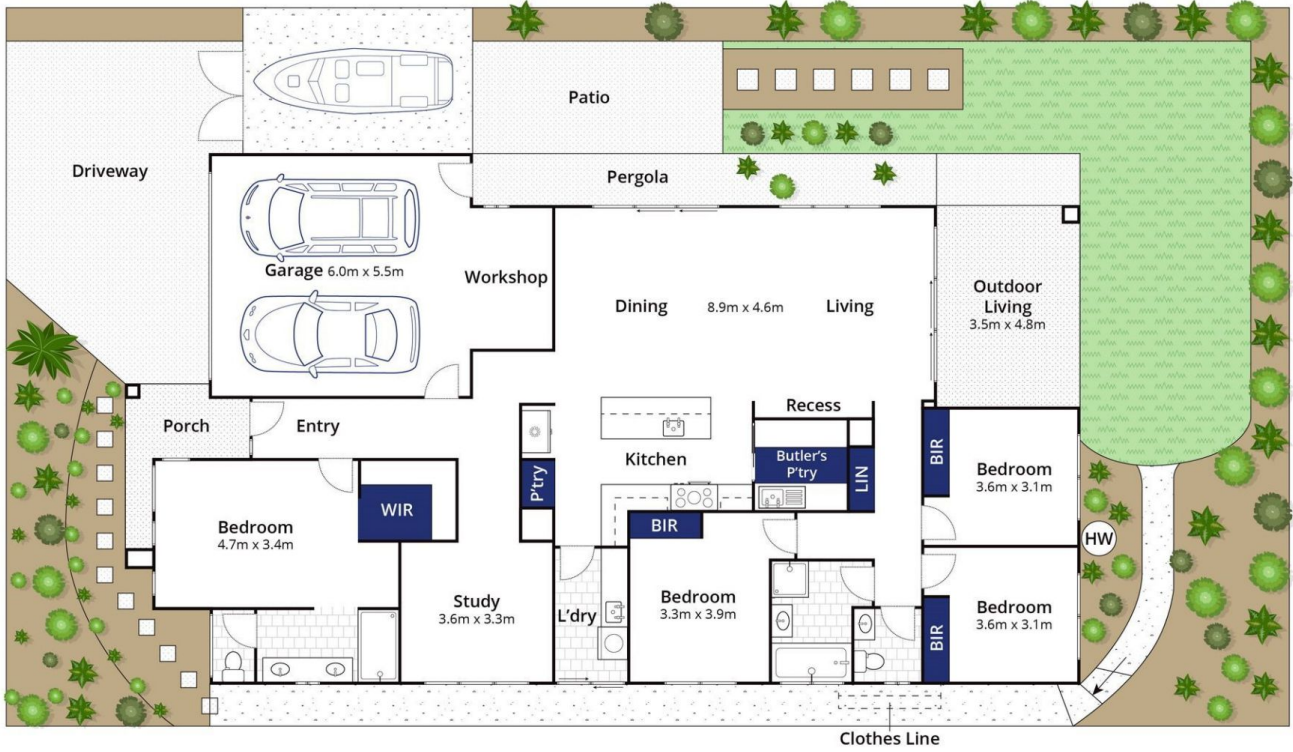

Whilst bwr.com.au has made every attempt to ensure the accuracy of the floor plan contained here, measurements are approximate and no responsibility is taken for any error, omission, or mis-statement. This plan is for illustrative purposes only.

17 Andale Avenue, Curlewis

bellarine property
Rentals | Commercial | Sales | Projects