



48 Cottesloe Drive Barwon Heads VIC

5 3 3

The Feel:

With all of the drawcards of a beachside haven, this recently renovated beauty combines original character with modern luxuries that exceed today's lifestyle demands. Every window rewards the beholder with leafy aspects, and the lure of garden gate access to the Moonah Forest is the stuff of fantasy. Set amongst native gardens bordering parkland, this large family home with ramp accessibility boasts the versatility of a spacious kitchen and meals area, 2 living areas, 5 bedrooms (2 with ensuites/WIRs) plus a dedicated home office with private entrance.

The Facts:

- Large 5 bedroom home with 3.5 baths, 2 living rooms plus versatile home office/3rd living on 585m2 (approx)
- Floor to ceiling glass & sliding doors facilitate impressive indoor/outdoor experience
- Very private aspect, fully fenced with rear gate access to Coastal Moonah Forest
- Resort-style master with treetop Moonah views, SSAC, WIR & luxurious hotel quality ensuite
- 4 more bedrooms on ground floor, all enjoy greenery aspects

Land Size : 585 sqm

View : <https://www.bellarineproperty.com.au/6352128>



Levi Turner
03 5254 3100



Peta Walter
03 5254 3100

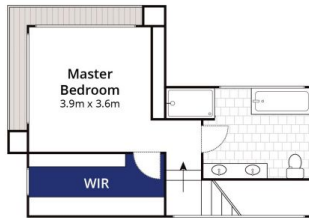

First Floor



Ground Floor

Whilst bwrm.com.au has made every attempt to ensure the accuracy of the floor plan contained here, measurements are approximate and no responsibility is taken for any error, omission, or mis-statement. This plan is for illustrative purposes only.

48 Cottesloe Drive, Barwon Heads

bellarine **b** **property**
Rentals | Commercial | Sales | Projects