



3/6 Hazelwood Crescent Leopold VIC

3 2 2

The Feel:

An outstanding opportunity presents for those looking to purchase in an established, family-friendly pocket with convenient proximity to the shops, schools & nearby amenities. Ideal for couples, singles or small families, secure your lifestyle or investment property now in one of four units in this block. All feature open plan living, high spec kitchens with stainless steel appliances, alfresco entertaining areas, 3 bedrooms (master with en suite/WIR) & double garages, only 5mins to Gateway Plaza Shopping Centre.

The Facts:

- Striking modern finishes throughout
- Open plan design maximising interior living space
- 3BR, 2 bathroom and RC DLUG
- Stone benchtops, SS apps, stunning cabinetry
- Private alfresco deck area
- Carpets & engineered timber floors
- Reverse cycle heating and cooling throughout
- Great location offering a fuss-free, low maintenance lifestyle
- A few short minutes by car to school and Gateway Plaza

Price : \$ 489,000

View : <https://www.bellarineproperty.com.au/6351885>



Dan Halsey
03 5254 3100



Lee Martin
03 5297 3888

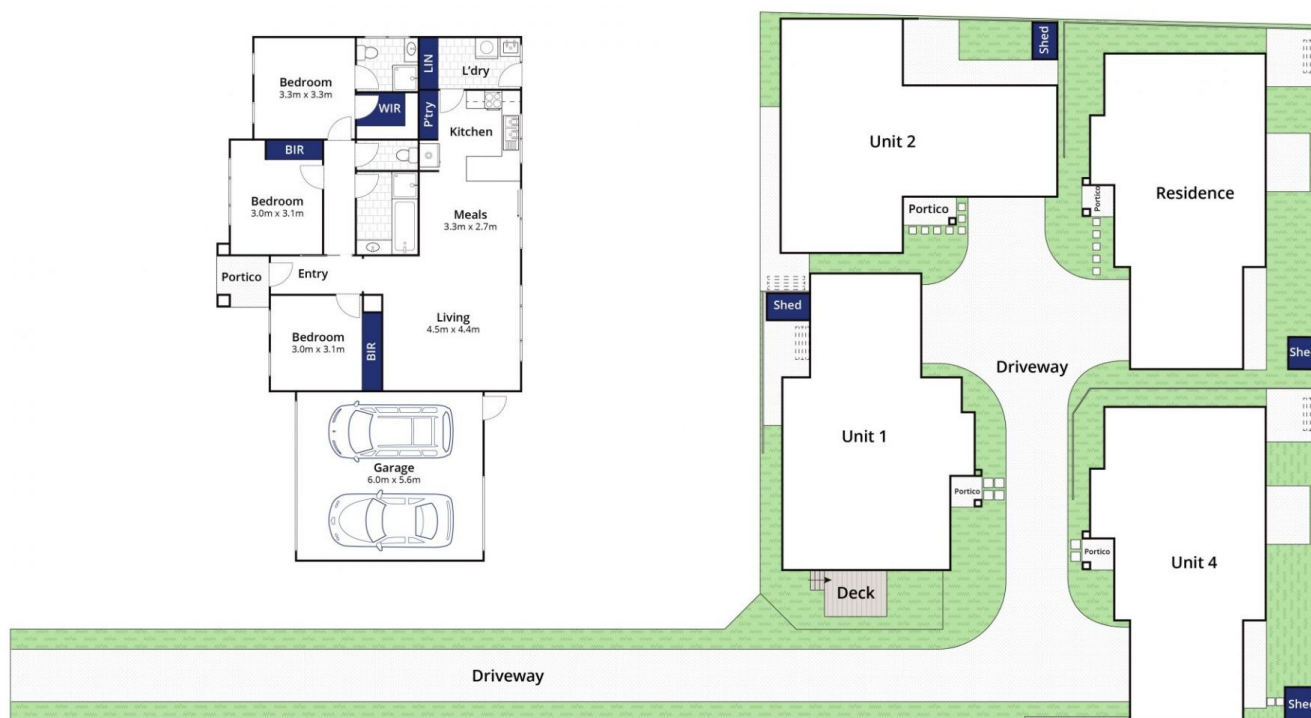

Whilst bwrm.com.au has made every attempt to ensure the accuracy of the floor plan contained here, measurements are approximate and no responsibility is taken for any error, omission, or mis-statement. This plan is for illustrative purposes only.

3/6 Hazelwood Crescent, Leopold

bellarine **b**property