



**119-121 Cashmore Drive Connewarre VIC**

5 3 3

#### The Feel:

Carefully planned to integrate with its surroundings, this 'builder's own home' epitomises true craftsmanship & lifestyle-driven design. Built to the highest quality, you will never outgrow this home. Two master suites offer resort-style luxury with high-end finishes, while three more bedrooms have built-in desks & BIRs. From the Silvertop Ash timber cladding & high entrance door, to soaring tilt panel concrete walls, this property showcases a natural palette of materials, enveloping a sheltered, private enclave with mineral pool for the best in outdoor living.

#### The Facts:

- Custom 'builder's own home' by Basebuild Constructions with Lachlan Shepherd Architects
- Clever family friendly floorplan equates to a house you'll never outgrow
- 4m high ceilings & tilt panel concrete walls are artworks unto themselves
- Premium Colorbond 'Monument' Nailstrip cladding extends to internal walls & entrance ceiling
- Silvertop Ash timber cladding & high entrance door embody the simplicity & functionality within

**Land Size** : 874 sqm

**View** : <https://www.bellarineproperty.com.au/5647704>



**Levi Turner**  
03 5254 3100



**Peta Walter**  
03 5254 3100

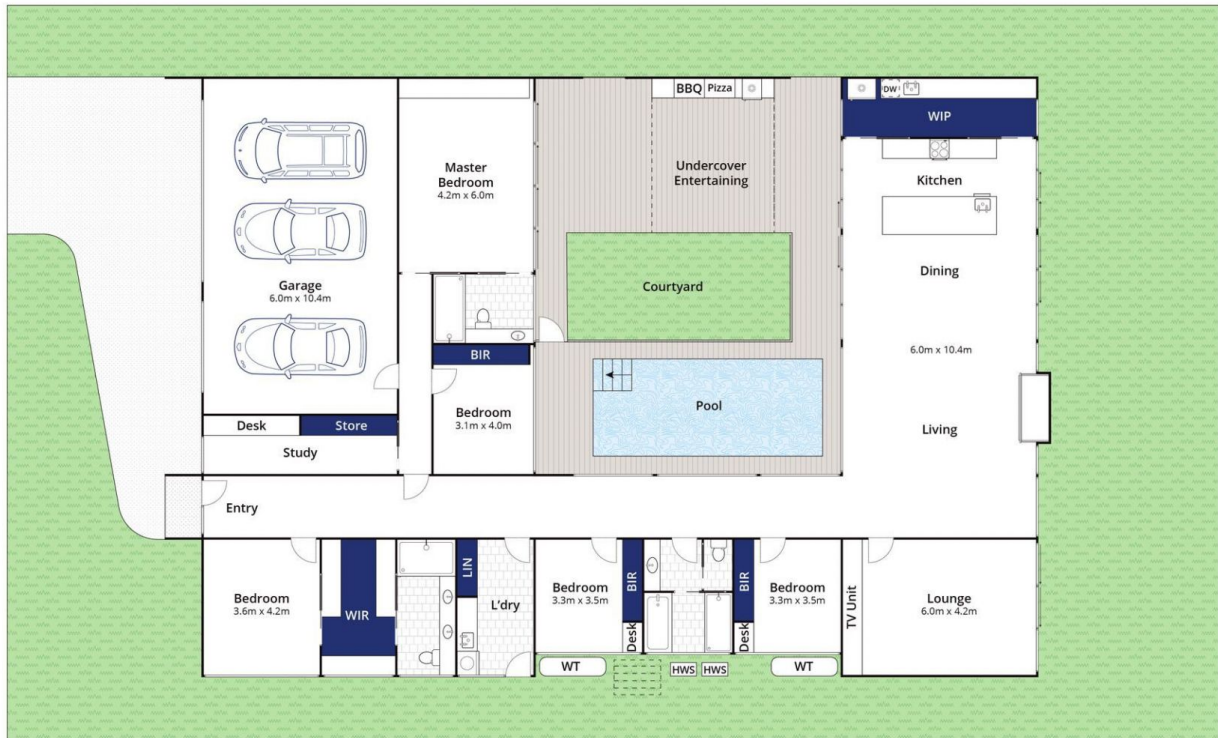

Whilst [bwrm.com.au](http://bwrm.com.au) has made every attempt to ensure the accuracy of the floor plan contained here, measurements are approximate and no responsibility is taken for any error, omission, or mis-statement. This plan is for illustrative purposes only.

**119-121 Cashmore Drive, Connewarre**

bellarine **b**property