



6 Milborne Drive Ocean Grove VIC

4 2 3

The Feel:

With a versatile floorplan that can comfortably accommodate a home business, this beautifully presented lifestyle home opens up a world of possibilities for how you live & work. Spa-side alfresco living creates a resort-style feel, while the 4 indoor living zones & 4 spacious bedrooms enable this home to take the demands of a large family in its stride. If nearly 800m2 isn't enough, the Kingston Downs Reserve is a few steps away, with shops, schools & the region's beaches within easy reach.

The Facts:

- 2-storey design on a generous block, offering almost 800sqm of space
- Sunny north east aspect maximised for indoor/outdoor living
- Alfresco area with heated spa & extensive deck to entertain the family & friends
- Established, private Balinese-style gardens
- Kitchen/living/dining areas, adjoining a sitting room with gas log fireplace

Land Size : 789 sqm

View : <https://www.bellarineproperty.com.au/5356175>



Dan Halsey
03 5254 3100

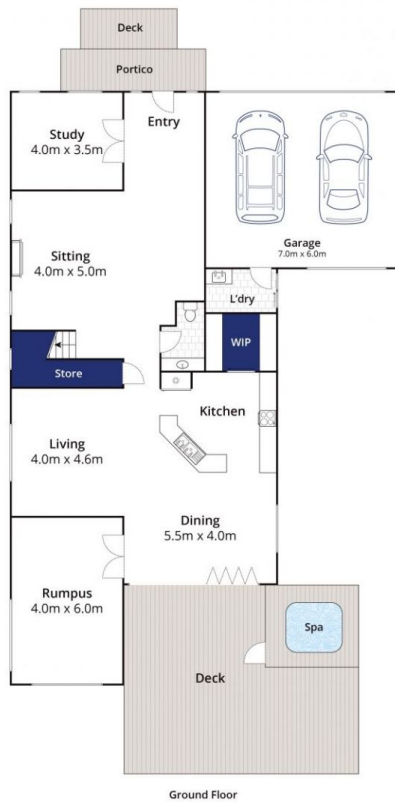

Whilst bwrm.com.au has made every attempt to ensure the accuracy of the floor plan contained here, measurements are approximate and no responsibility is taken for any error, omission, or mis-statement. This plan is for illustrative purposes only.

6 Milborne Drive, Ocean Grove

bellarine **b**property