



361-409 Swan Bay Road Wallington VIC

5 5 10

The Feel:

"Dandarragan? meaning good land, is located in a peaceful setting whilst being convenient to all the amenities of the Bellarine Peninsula. This elegant, spacious and modern property incorporates a pool, equestrian facilities, stables, fenced paddocks and a separate converted sheering shed dwelling. Set on approx. 25 acres of prime rural land, this tightly held site offers an unrivalled lifestyle opportunity & absolute privacy.

The Facts:

- Spacious 4 to 5BR plus home nestled on far-reaching acreage behind shelterbelts, established trees and garden
- Breathtaking entrance & grand staircase with views to pool and garden
- Ground floor has open plan living, dining, kitchen, study, an entertaining room & sunken lounge with surrounding gallery
- Carpets with underfloor slab heating, additional heating, cooling & two large open fireplaces
- Elegant modern French Provincial kitchen with rangehood oven, gas cooktop, and WIP
- Impressive Brushbox timber bench & polished floorboards

Price : \$3,850,000-\$4,150,000
Land Size : 25 Acres
View : <https://www.bellarineproperty.com.au/52119>
 32



Lee Martin
 03 5297 3888



Toby Lee
 03 5254 3100

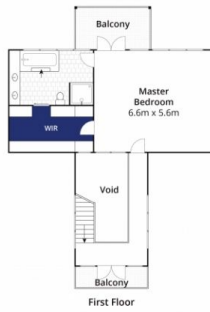

First Floor



(Not In Position)

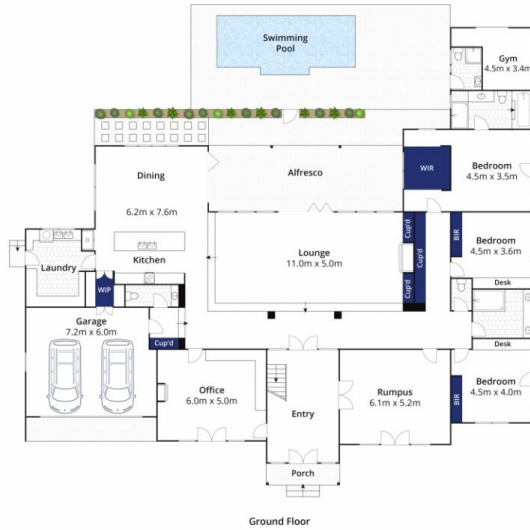

Ground Floor



Site Plan

Whilst bwrm.com.au has made every attempt to ensure the accuracy of the floor plan contained here, measurements are approximate and no responsibility is taken for any error, omission, or mis-statement. This plan is for illustrative purposes only.

361-409 Swan Bay Road, Mannerim

bellarine **b** property