



6/110 Tomara Drive Connewarre VIC

2 **1** **1**

The Feel:

Quietly located in the secure and peaceful 13th Beach Estate, this 2BR townhouse will appeal to those looking for a fuss free coastal lifestyle, with beachside benefits. Keen golfers will be impressed by the two award winning courses on offer, along with the modern clubhouse and facilities at hand. A fantastic option for buyers looking to downsize, invest or treat themselves to a holiday hideaway in a highly sought after location.

The Facts:

- OP kitchen, dining and living, bathed in natural light
- Streamlined galley kitchen with modern appliances
- Direct access to private patio for alfresco entertaining
- A short distance to the 13th Beach Golf Clubhouse
- Club facilities available for tenants and owners use
- Beautiful course outlooks providing a natural backdrop
- Peaceful location with an abundance of native birdlife
- 2 spacious BRs sharing a well equipped bathroom
- R/C air conditioning and cleverly concealed laundry
- Single level benefits for ease of access and lifestyle
- Detached SLUG, located in a secure gated community
- Track access onto 13th Beach for surf and summer swims

Price : \$ 415,000

View : <https://www.bellarineproperty.com.au/5176874>



Levi Turner
03 5254 3100



Peta Walter
03 5254 3100

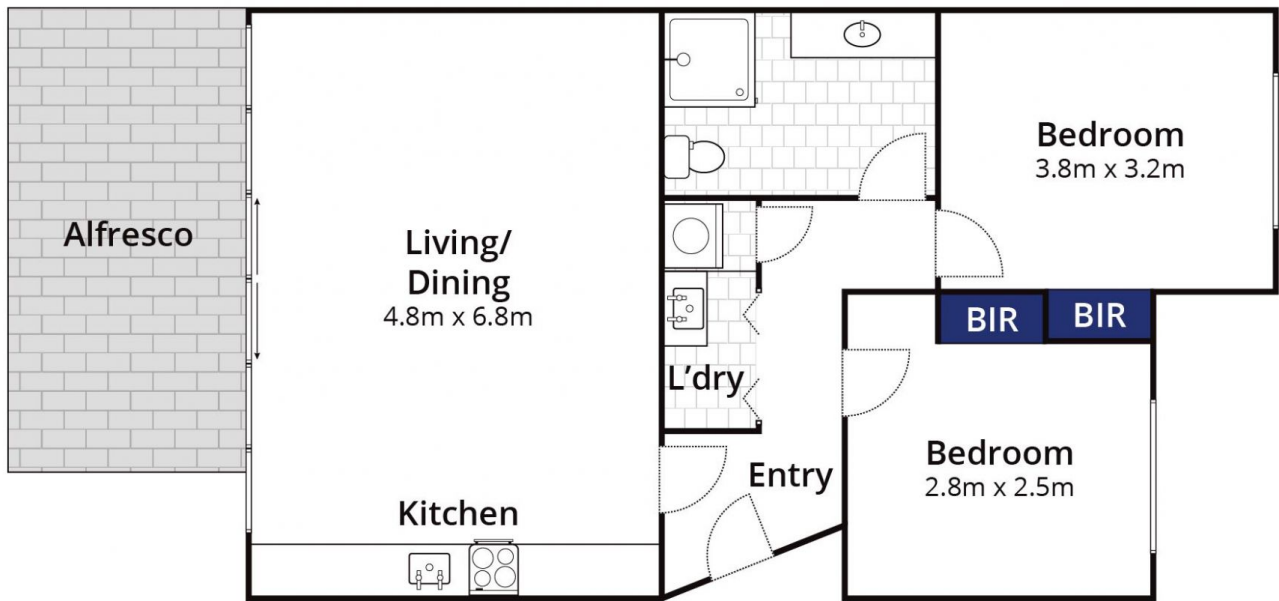

Whilst bwrn.com.au has made every attempt to ensure the accuracy of the floor plan contained here, measurements are approximate and no responsibility is taken for any error, omission, or mis-statement. This plan is for illustrative purposes only.

6/110 Tomara Drive, Connewarre

bellarine **b**property