



## 245 Curlewis Road Wallington VIC

3 2 4

Offers Closing Monday 2nd December at 4pm (Unless Sold Prior)

### The Feel:

Hidden away at the end of a country driveway lies a picture-perfect rural lifestyle opportunity on 3.7 (approx.) stunning acres. This 3 BR contemporary home with high raked ceilings is awash with light, offering verdant outlooks from every window to lawns & lovingly tended gardens. Dual living spaces & a well-equipped galley style kitchen provide breadth for individual or communal activities, with lots of sunny spots to sit & enjoy the peace & quiet of country life, only minutes to the surf beaches, local wineries and Geelong CBD.

### The Facts:

- Classic, contemporary 3BR + study nook home on 3.7 (approx.) picturesque acres
- Driveway leads to home, set back from the road, with 100% privacy of extensive Conifer planting
- Rural lifestyle opportunity in tightly held Curlewis Rd, Wallington
- Living zones maximise the sunny North & West aspects,

**Land Size** : 3.7 Acres

**View** : <https://www.bellarineproperty.com.au/5149409>



**Toby Lee**  
03 5254 3100



**Dan Halsey**  
03 5254 3100

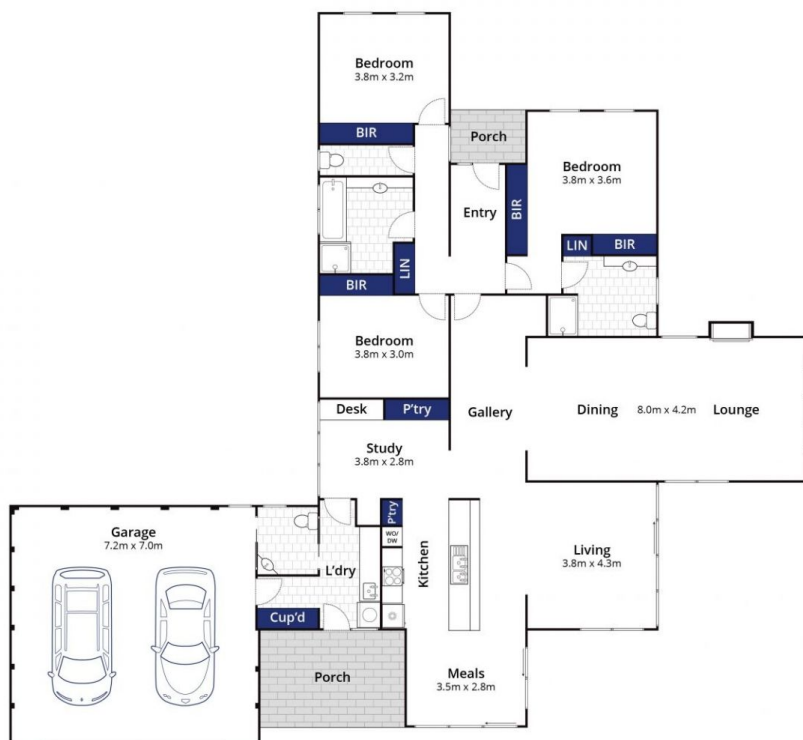

Whilst [bwrn.com.au](http://bwrn.com.au) has made every attempt to ensure the accuracy of the floor plan contained here, measurements are approximate and no responsibility is taken for any error, omission, or mis-statement. This plan is for illustrative purposes only.

**245 Curlewis Road, Wallington**

bellarine **b** property