



62-70 Caldwell Crescent Wallington VIC

4 2 6

Offers closing Monday 18th November (Unless Sold Prior)

The Feel

Approx 3.7 picturesque acres of prime land, with a classic rural weatherboard home nestled perfectly within, captures the northerly aspect & fully landscaped garden views. Privacy & tranquility are on offer, with the privilege of space, potential for hobby farm with large shed, & the rewards of a self-sufficient lifestyle. Inspired by classic Victorian era, this stunning home meets today's modern needs.

The Facts

- Meandering driveway lined with established Manchurian Pear trees & metal edging, creates a stunning first impression
- Gardens & lawn extend beyond the large north-facing alfresco with pictorial outlooks over expansive lawns for backyard cricket, footy & entertaining
- The custom built home is welcoming, brimming with contemporary charm & gables that hark back to 1920s influences
- Indoors, the 4 BR children's wing is zonable directly off the

Price : \$ 1,740,000
Land Size : 3.7 Acres
View : <https://www.bellarineproperty.com.au/5102041>



Dan Halsey
03 5254 3100



Toby Lee
03 5254 3100

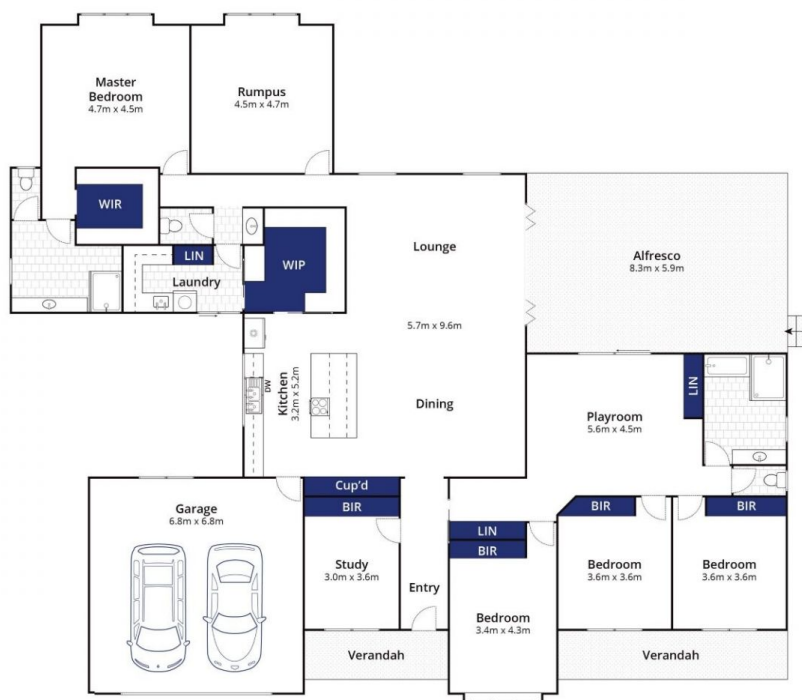

Ground Floor



Site Plan

Approx House Area 330m²
Approx Land Area 14977m²

Whilst bwrm.com.au has made every attempt to ensure the accuracy of the floor plan contained here, measurements are approximate and no responsibility is taken for any error, omission, or mis-statement. This plan is for illustrative purposes only.

62-70 Caldwell Crescent, Wallington

bellarine **b** property