



### 15B Heath Close Ocean Grove VIC

3 2 2

Available for private inspection. Please contact the listing agents to arrange your private viewing

#### The Feel:

This 'Old Grove' original has been beautifully refreshed from the landscaped coastal gardens to the stylishly renovated interiors, making way for a modern low-maintenance home that's ready to enjoy! Whether it's for holidays or permanent living, enjoy the tranquillity of this coveted court location, renowned for its peaceful bushland aspects and easy walks to cafes, aquatic centre and beaches.

#### The Facts:

- Original 3BR home masterfully updated by 'Homes By Chapman'
- Easy care block within a peaceful tree lined court on own title
- Spacious downsize, low-maintenance home or holiday let
- Restored Vic Ash flooring, SSAC and gas log fire to lounge
- Matte black fixtures and cabinetry to kitchen with wide breakfast bar

**Land Size** : 373 sqm

**View** : <https://www.bellarineproperty.com.au/5014446>



**Dan Halsey**  
03 5254 3100

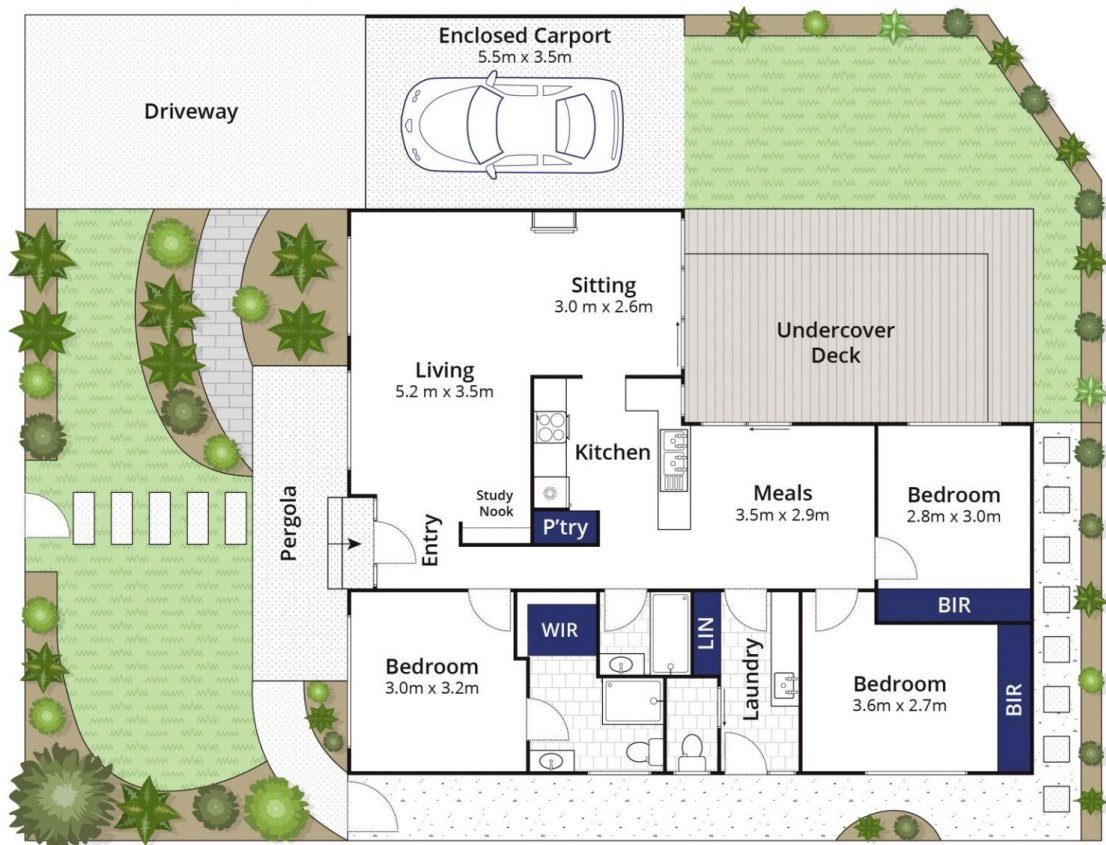

Whilst [bwrn.com.au](http://bwrn.com.au) has made every attempt to ensure the accuracy of the floor plan contained here, measurements are approximate and no responsibility is taken for any error, omission, or mis-statement. This plan is for illustrative purposes only.

**15 Heath Close, Ocean Grove**

bellarine **b**property