



2/22 Everist Road OCEAN GROVE VIC

2

This brand new warehouse offers an outstanding opportunity within one of Victoria's busiest and most popular coastal locations. Positioned in the developing and sought after Ocean Grove industrial estate, the design and layout of the property lends itself to a number of uses. The Ocean Grove industrial estate has had a transformation in the past 12-18 months with the inclusion of a brewery, yoga studio, salt therapy and floatation centre, coffee shop, and others. What was once reserved for trades and manufacturing of goods, has changed into a thriving centre for the arts, hospitality and many more.

The Facts:

Floor space of 115m²

Two off street car spaces with ample more room inside the property

5.1m roller door proving outstanding entry clearance and access

7m ceilings lends itself to the addition of a mezzanine for additional storage and/or offices

Disabled toilet and kitchenette facilities

Price : \$ 385,000
Building Size : 115 sqm
View : <https://www.bellarineproperty.com.au/4964764>



Levi Turner
03 5254 3100



Christian Bartley
03 5254 3100

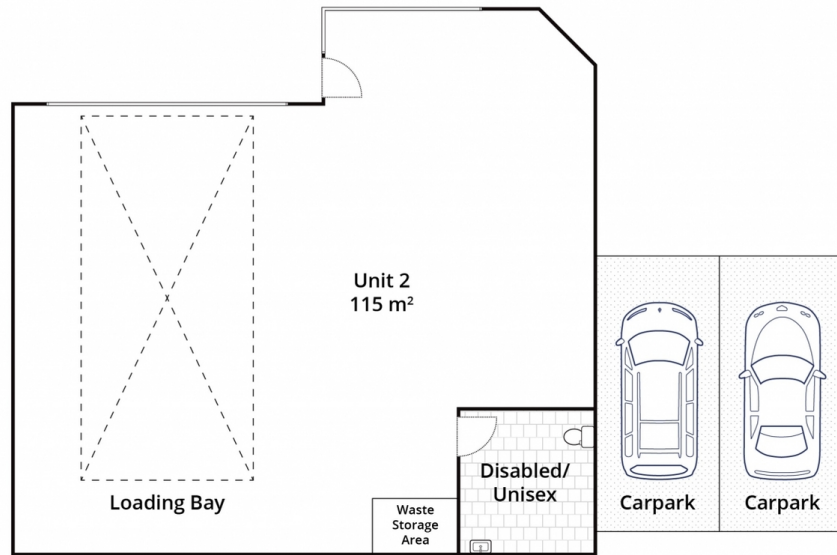

Ground Floor

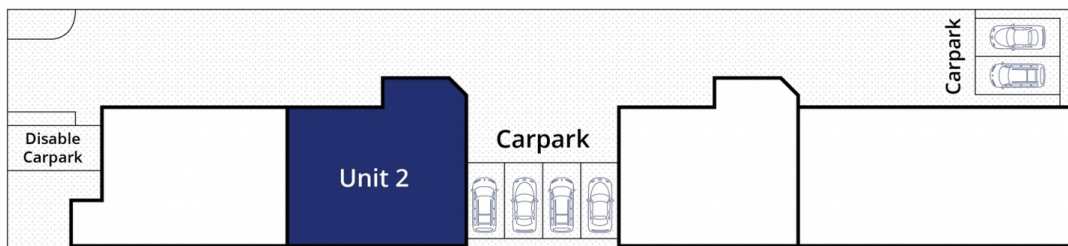

Site Plan

Approx House Area 115m²
Approx Land Area 1.064m²

Whilst bwrn.com.au has made every attempt to ensure the accuracy of the floor plan contained here, measurements are approximate and no responsibility is taken for any error, omission, or mis-statement. This plan is for illustrative purposes only.

22 Everist Road, Ocean Grove

bellarine **b**property