



2/134 Fellows Road Point Lonsdale Vic

3 1 2

The Feel:

Quietly positioned just a few streets from the foreshore for summer, this solid O'Dowd built townhouse feels more like a home with private indoor and outdoor living zones you're going to love.

Floor to ceiling glazing allows light to flood the interior, which has been partially updated ensuring you can move straight in and relax, unwind and enjoy the laid back lifestyle of Point Lonsdale.

The Facts:

- Custom O'Dowd built townhouse set upon 402sqm approx.
- Separately titled with private entry via north facing courtyard
- OP living, dining and kitchen with wood fire and SSAC
- Heightened doors and ceilings, with timber laminate flooring
- New Caesarstone benchtops, d/w and electric cooking to kitchen
- Indoor/outdoor sunroom with yard access + north facing lawn
- Master with BIRs and access to 2-way bathroom with

Price : \$ 640,000
Land Size : 402 sqm
View : <https://www.bellarineproperty.com.au/4947347>



Lee Martin
03 5297 3888

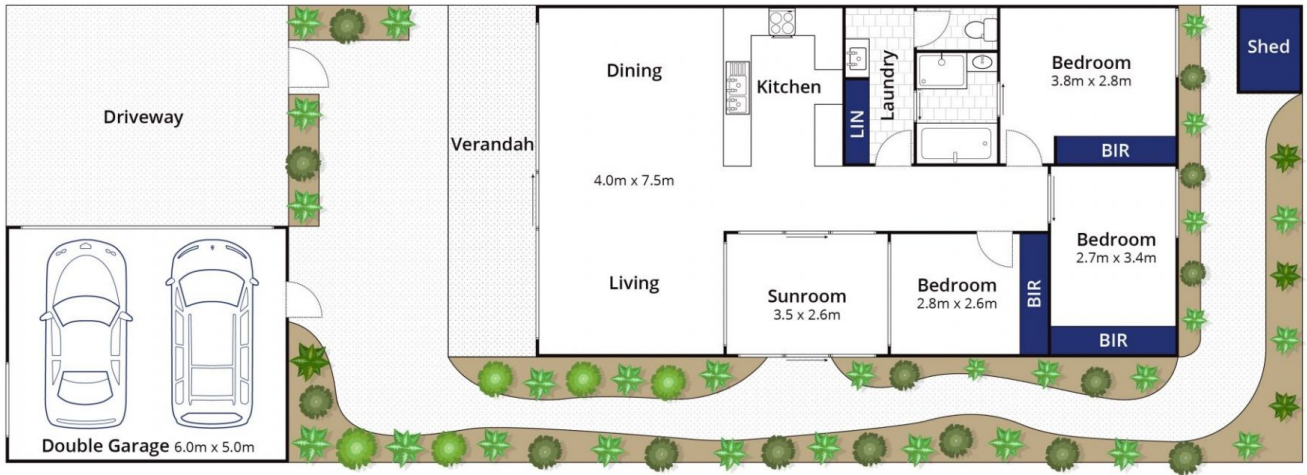

Whilst bwrn.com.au has made every attempt to ensure the accuracy of the floor plan contained here, measurements are approximate and no responsibility is taken for any error, omission, or mis-statement. This plan is for illustrative purposes only.

2/134 Fellows Road, Point Lonsdale

bellarine  property