



**32a Wattlebird Crescent Barwon Heads Vic**

3 2 1

**The Feel:**

This custom built home offers an abundance of space and style across two stunning levels, with a design that promotes an outdoor lifestyle, whilst capturing bushland views at every opportunity. Positioned in an established riverside pocket you'll feel hidden away when you need it most, with boardwalks along the Barwon River ensuring a positive reconnection with nature steps from home.

**The Facts:**

- 3BR dual level townhouse in established river-end of town
- Ideal weekender, modern downsize or low-maintenance home
- Modern open plan design focuses on entertaining and style
- Natural façade features Silver Top Ash decks and cladding
- Glass sliders to two north facing decks for entertaining ease
- Tasmanian oak floors, custom cabinetry and staircase
- Stylish timber and soft grey joinery to kitchen
- Smeg oven and cooktop, pantry with soft close drawers
- Lounge features custom cabinetry and gas log fire
- Stylish laundry with great bench space and timber

**Price** : \$ 932,000  
**Land Size** : 323 sqm  
**View** : <https://www.bellarineproperty.com.au/4936361>



**Levi Turner**  
03 5254 3100



**Peta Walter**  
03 5254 3100

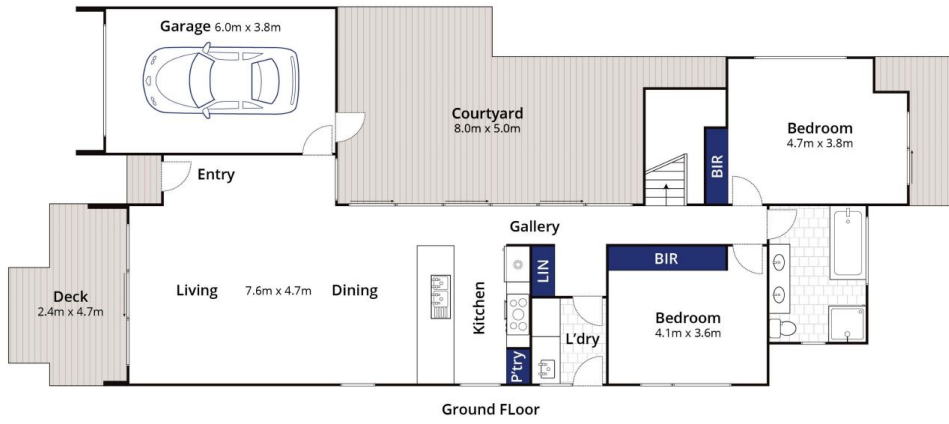

Ground Floor



First Floor



Site Plan

Approx House Area 180m<sup>2</sup>  
Approx Land Area 322m<sup>2</sup>

Whilst [bwr.com.au](http://bwr.com.au) has made every attempt to ensure the accuracy of the floor plan contained here, measurements are approximate and no responsibility is taken for any error, omission, or mis-statement. This plan is for illustrative purposes only.

## 32A Wattlebird Crescent, Barwon Heads

