



17-19 Buccleugh Street Drysdale VIC

4 🚗 4 🚗 3 🚗

The Feel:

Calling all business owners, artists, large families and car enthusiasts! This home is the definition of versatility. Providing a country lifestyle without compromising on space and shedding, this property offers two dwellings plus a large shed and studio. The bordering trees, the chirping birds and established vegetable patch give you a sense of the country, while the shops and schools are only a short walk away. Soak up the peace and tranquillity; take a leisurely walk along the nearby rail trail or potter in the garden - what a lifestyle!

The Facts:

- Sprawling over an acre (approx), surrounded by established trees and gardens
- The main homestead offers three large bedrooms, study and two living areas
- The large kitchen and living area overlook the garden and paved alfresco area
- Master with spacious walk in robe and ensuite
- The new pergola and front deck greet you upon entry of the main home
- Large 3-car garage and workshop with built-in studio,

Price : \$ 835,000
Land Size : 4060 sqm
View : <https://www.bellarineproperty.com.au/4629405>



Lee Martin
03 5297 3888



Ground Floor

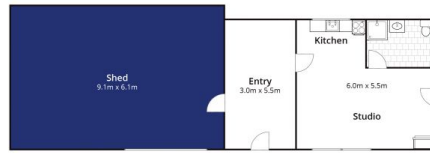

(Not in Position)

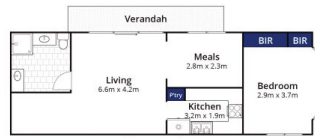

Self Contained Unit

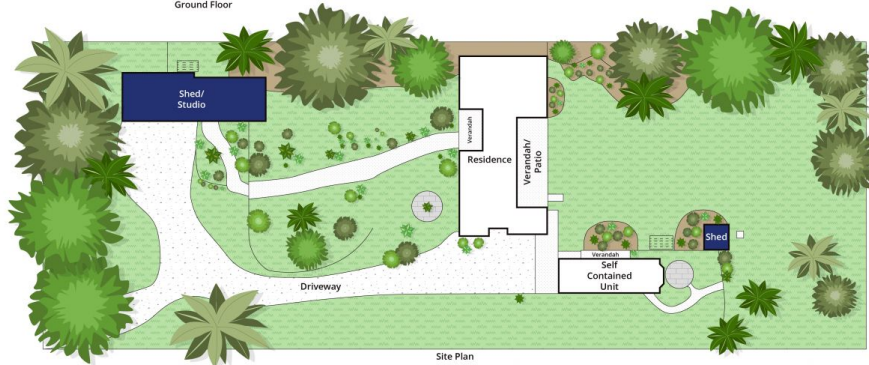

Site Plan

Whilst bwrn.com.au has made every attempt to ensure the accuracy of the floor plan contained here, measurements are approximate and no responsibility is taken for any error, omission, or mis-statement. This plan is for illustrative purposes only.

17-19 Buccleugh Street, Drysdale

bellarine  property