



**411-419 Wallington Road Wallington VIC**

**4** **2** **2**

**The Feel:**

Providing the highest quality in family living and the traditional elegance of a country estate, this stunning family home offers the ultimate country lifestyle moments from Ocean Grove amenities.

A place of perfect peace and elemental harmony, with lush green paddocks, established gardens and glistening poolside entertaining - providing all the space your growing family will ever need.

**The Facts:**

- Set within established garden surrounds, in prestigious Wallington on 5.48 Acres approx.
- Be formally greeted by the Dry stacked Dromana granite driveway entrance
- A classic country home, brimming with traditional charm and thoughtful contemporary updates
- Easy 6min drive to all Ocean Grove amenities, with Wallington Primary only 2mins down the road
- Immaculately landscaped circular driveway exhibits the elegant ambience of a country estate
- A crisp white weatherboard façade is wrapped by a long veranda, with a grand glazed entrance

**Land Size** : 5.48 Acres

**View** : <https://www.bellarineproperty.com.au/4483423>



**Toby Lee**  
**03 5254 3100**



**Peta Walter**  
**03 5254 3100**

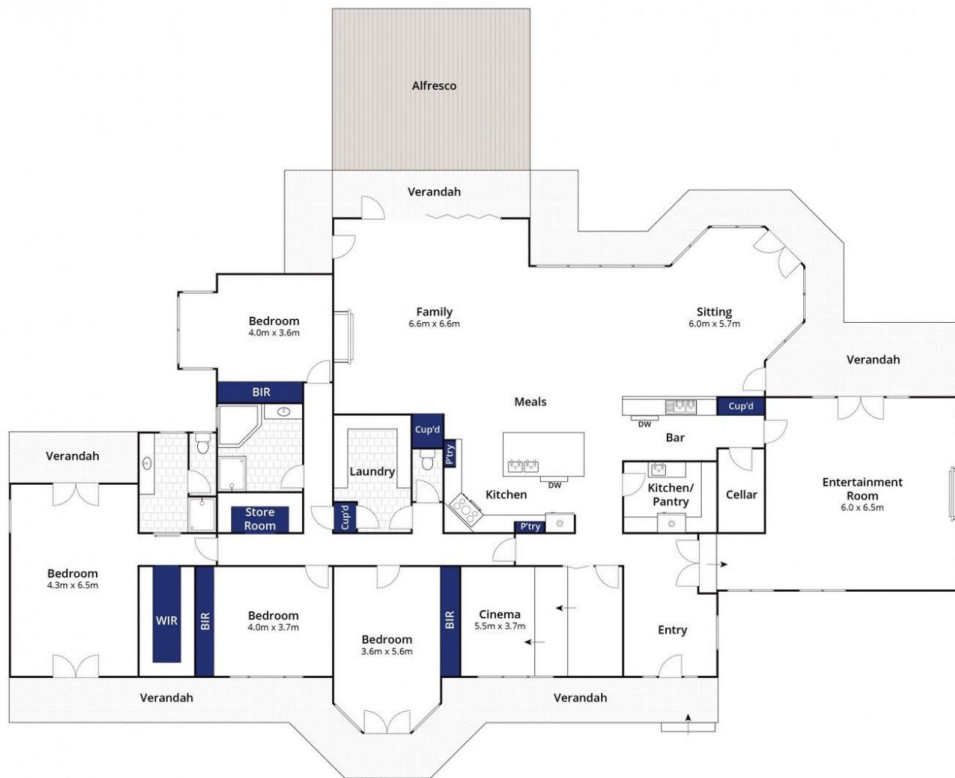

Whilst [bwrm.com.au](http://bwrm.com.au) has made every attempt to ensure the accuracy of the floor plan contained here, measurements are approximate and no responsibility is taken for any error, omission, or mis-statement. This plan is for illustrative purposes only.

**411-419 Wallington Road, Wallington**

bellarine **b** property