



## 23-25 Omega Drive Ocean Grove VIC

4 🚗 2 🚗 2 🚗

A dream home for families who love entertaining! With multiple living areas and an open plan kitchen which seamlessly links to the outdoor alfresco area, there is plenty of room for everyone to enjoy this fabulous coastal home. High ceilings and wide hallways make this spacious family home feel instantly welcoming. Set on a corner block, opposite the park and at the centre of the tree lined and peaceful Oakdene Estate, you'll have everything at your fingertips, right in the heart of the Bellarine.

**Price** : \$ 630,000  
**Land Size** : 660 sqm  
**View** : <https://www.bellarineproperty.com.au/42486>  
 15



**Dan Halsey**  
 03 5254 3100

- ? This is open plan living at its finest - twin living zones seamlessly link to the alfresco!
- ? Timber framed bi-fold doors open to the deck and garden, perfect for summer entertaining
- ? Set on an impressive corner block, opposite the local park in the peaceful Oakdene Estate
- ? Versatile floor plan with multiple living areas and plenty of room for your family to grow
- ? With views of the garden, the roomy living room is the perfect relaxation spot
- ? The wide hallway creates a welcoming entry to this contemporary, move in ready home
- ? Gifted with high 2.4m ceilings throughout, providing a

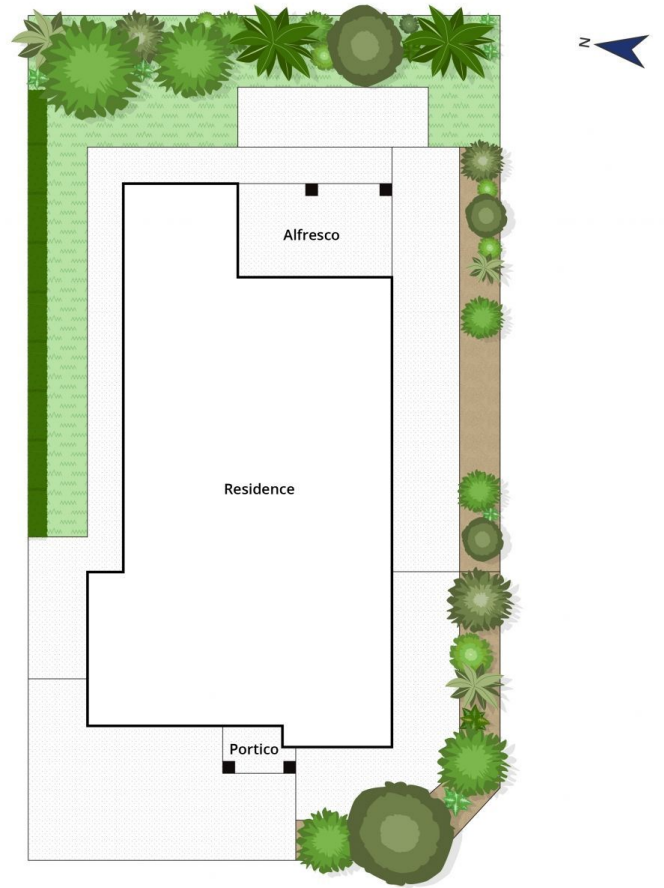
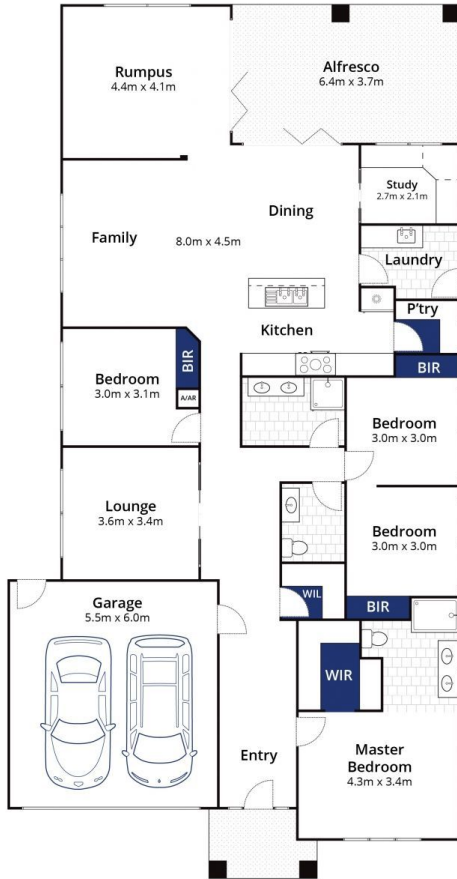

Whilst [bwr.com.au](http://bwr.com.au) has made every attempt to ensure the accuracy of the floor plan contained here, measurements are approximate and no responsibility is taken for any error, omission, or mis-statement. This plan is for illustrative purposes only.

**22-24 Omega Drive, Ocean Grove**

bellarine  property