



28 Trevally Drive Ocean Grove VIC

4 3 2

Set beyond an opulent double storey facade, this grand residence boasts a perfect blend of space and style with an emphasis on family togetherness. Wide open entertaining spaces are blessed with breathtaking ocean views encompassing Point Lonsdale Lighthouse, Queenscliff, out to the Heads of Port Phillip Bay and beyond.

- Exceptional zoned living across a highly versatile family floorplan, and perfect for extended family
- Set among cottage style gardens over 785sqm (approx.), with lawns for playtime or a pool (STCA)
- Behind the classic façade lies a grand entrance hall of soaring ceilings and rich hardwood floors
- A sitting room with a fireplace and mantle as the centrepiece sets a refined tone upon entry
- Guests can drop their bags in a bedroom by the stairs, set quietly at the façade by a powder room
- Spacious and well-appointed kitchen forms the central hub of the home, with long breakfast bench
- Westinghouse oven and gas cooktop, dishwasher, walk-in pantry and abundant storage
- Open living and capacious formal dining boast water views, hosting family celebrations with ease

Price : \$ 900,000
Land Size : 785 sqm
View : <https://www.bellarineproperty.com.au/4124249>



Toby Lee
03 5254 3100



Dan Halsey
03 5254 3100

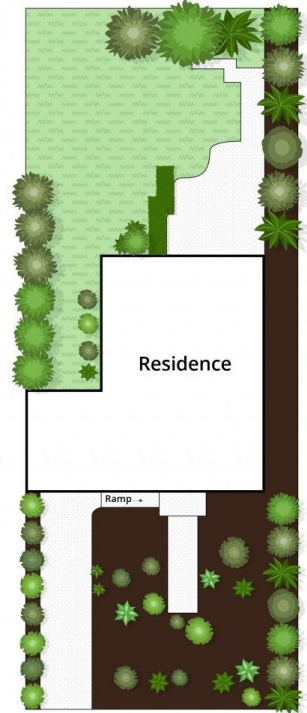

Whilst bwrn.com.au has made every attempt to ensure the accuracy of the floor plan contained here, measurements are approximate and no responsibility is taken for any error, omission, or mis-statement. This plan is for illustrative purposes only.

28 Trevally Drive, Ocean Grove

bellarine **b** property