



45 Thomson Drive Barwon Heads VIC

2 2 1

AUCTION SATURDAY MARCH 10TH 2018 AT 11AM (UNLESS SOLD PRIOR)

Blessed with a picturesque rural aspect in sought-after Thomson Drive, this solid mud brick cottage will ignite your imagination. Add to this a premier position close to schools, beaches and only a short walk from all the action of Hitchcock Avenue - and you've got a home with serious potential.

- Solid mud brick home surrounded by tranquil native gardens on a flat 595sqm (approx.)
- Capture brilliant rural sunsets over an uninterrupted horizon from a second storey deck (STCA)
- Versatile floorplan for a quick cosmetic update utilising existing layout without costly alterations
- Live in now and await future development (STCA), or let out easily in this sought after area
- Orientated towards open plan living and dining, is a well laid out kitchen filled with natural light
- A small storage room could become the perfect butler's pantry, located just behind the kitchen wall
- Glass doors lead out to a northern terrace from the dining

Price : \$ 805,000
Land Size : 595 sqm
View : <https://www.bellarineproperty.com.au/4103233>



Peta Walter
03 5254 3100



Levi Turner
03 5254 3100



Ground Floor

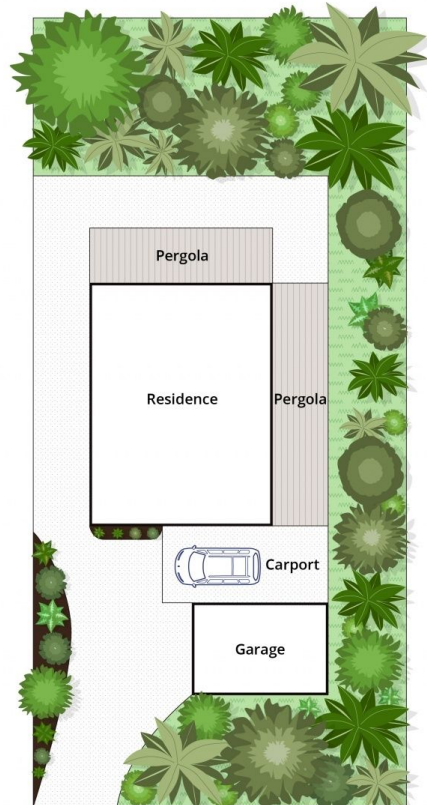

Site Plan

Approx. Area 87m²

Whilst bwr.com.au has made every attempt to ensure the accuracy of the floor plan contained here, measurements are approximate and no responsibility is taken for any error, omission, or mis-statement. This plan is for illustrative purposes only.

45 Thomson Drive, Ocean Grove

bellarine **b**property