



24-26 Cemetery Road Drysdale VIC

4 2 4

Perfectly orientated on 4922m2 (approx), harnessing northern aspects and stunningly orchestrated garden outlooks, this property of privileged proportions is guaranteed to impress. With a breathtaking natural ambiance, timeless design is fused with modern conveniences and sun-filled living zones to create a welcoming and simply beautiful family home. If you've been dreaming of the perfect tree-change with coastal benefits close by, please step this way!

Price : \$ 1,035,000
Land Size : 4922 sqm
View : <https://www.bellarineproperty.com.au/3986460>



Lee Martin
03 5297 3888



Levi Turner
03 5254 3100

- Set at the end of quiet court on over an acre of picturesque, immaculately landscaped grounds
- Sunny northern aspects are enjoyed from the OP kitchen, living and meals area, with inviting garden views
- The recently upgraded luxury kitchen boasts Miele/Siemens apps, stone benchtops and polished finishes
- This light filled space is a welcoming heart to the home, perfect for family gatherings of epic proportions
- Direct access to the sun infused outdoor patio with established trees providing organic privacy
- A separate parents wing enjoys solitude from the busy nucleus, with commodious BIRs and ensuite

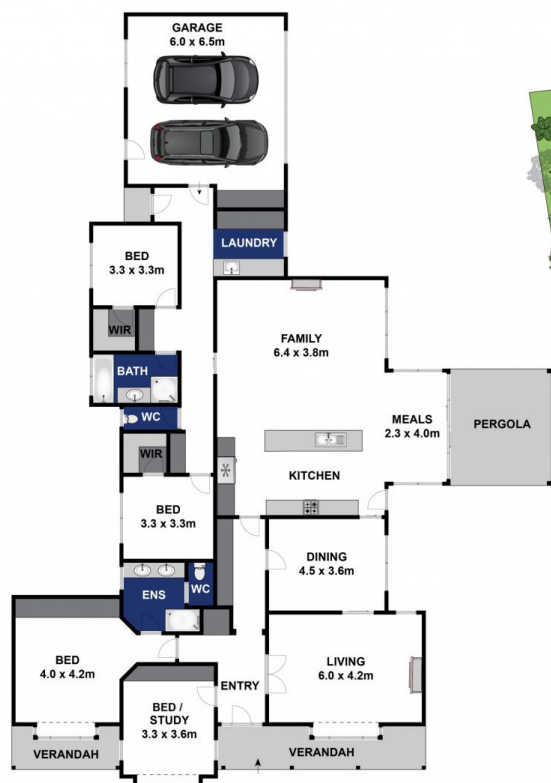

Whilst bwrn.com.au has made every attempt to ensure the accuracy of the floor plan contained here, measurements are approximate and no responsibility is taken for any error, omission, or mis-statement. This plan is for illustrative purposes only.

24-26 Cemetery Road, Drysdale

bellarineproperty