

28 Ewing Blyth Drive Barwon Heads VIC

5 3 2

Set in a prestigious Barwon Heads location on ascent to The Bluff, this sophisticated coastal home delivers a superior coastal lifestyle. Just metres from the picturesque river mouth, world class surf beaches and boutique coastal village, the idyllic location is key. The high-end home honors the location and boasts a generous plan incorporating 5 bedrooms, 4 living zones and 3 bathrooms.

- Infused with natural light, the generous floor plan flows seamlessly from indoors to out
- Multiple zones connect with gorgeous decks and garden boosting the lifestyle within
- Ground level is the adult's domain with private master, 3 big living zones, kitchen and guest suite
- The powder room, bathroom, laundry and garage add convenience to this open plan level
- The upper level, with 3 BRs, rumpus and bathroom, provides children a space of their own
- Wide Dekton entry steps and a Spotted Gum pergola create a stunning private entry
- Custom made front door on hydraulic pivot with Italian door furniture and lock
- Impressive entrance hall with polished Venetian plaster

Land Size : 834 sqm

View : <https://www.bellarineproperty.com.au/3970588>



Christian Bartley
03 5254 3100



Levi Turner
03 5254 3100

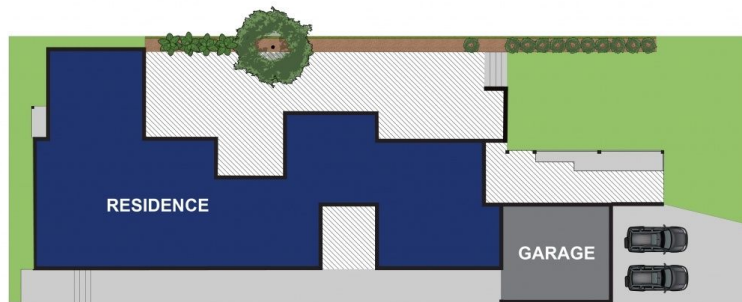
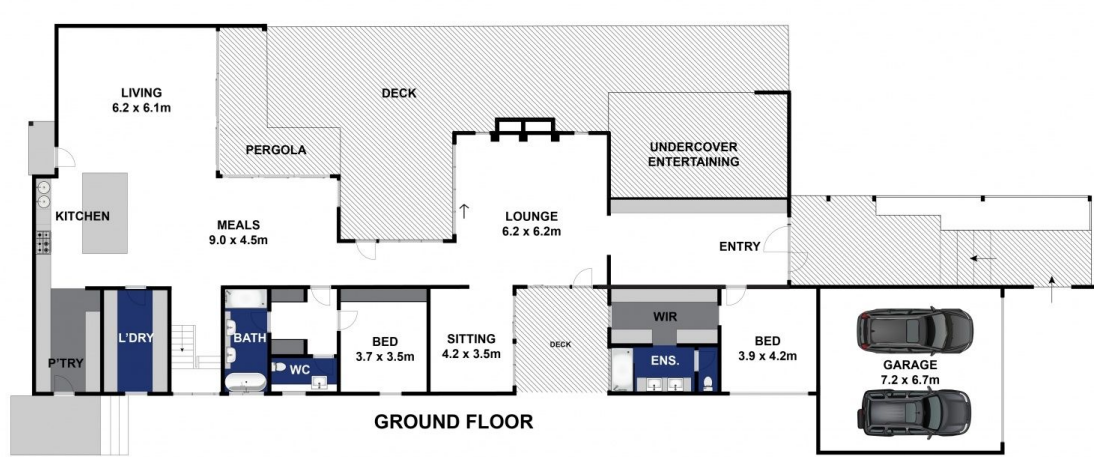

Whilst bwrn.com.au has made every attempt to ensure the accuracy of the floor plan contained here, measurements are approximate and no responsibility is taken for any error, omission, or mis-statement. This plan is for illustrative purposes only.

28 Ewing Blyth Drive, Barwon Heads

bellarineproperty