



## 10 Hampden Close Barwon Heads VIC

4 2 2

Perfectly positioned in a quiet leafy cul-de-sac within an easy stroll to 'The Mews' parkland, is this 4-bedroom home perfectly placed for a new family. With an intuitive floor plan and solid brick retro 'bones' you will have a superb canvas to add your own creative style and flair.

**Price** : \$ 780,100  
**Land Size** : 680 sqm  
**View** : <https://www.bellarineproperty.com.au/3939997>

- North-east facing light filled open plan kitchen/dining/living area
- Kitchen: Chef oven, Blanco 5-gas burner cooktop, F&P dishwasher, microwave nook & built-in pantry.
- Privately zoned master bedroom with WIR and ensuite
- Carpet to all bedrooms for warmth and comfort
- Centrally located for the minor bedrooms is the bathroom: shower, bath, vanity & separate WC
- Comfortable climate living: woodheater, ceiling fans & gas heater
- Smart energy saver with a Solar booster HWS
- Outdoor entertaining: undercover patio + large sun soaked yard
- An additional feature to the open plan living area is a separate north facing large office/studio with exterior access. Perfect as is, or create a teenage retreat.
- Treehouse fun for the kids with the established trees



**Levi Turner**  
03 5254 3100



**Peta Walter**  
03 5254 3100



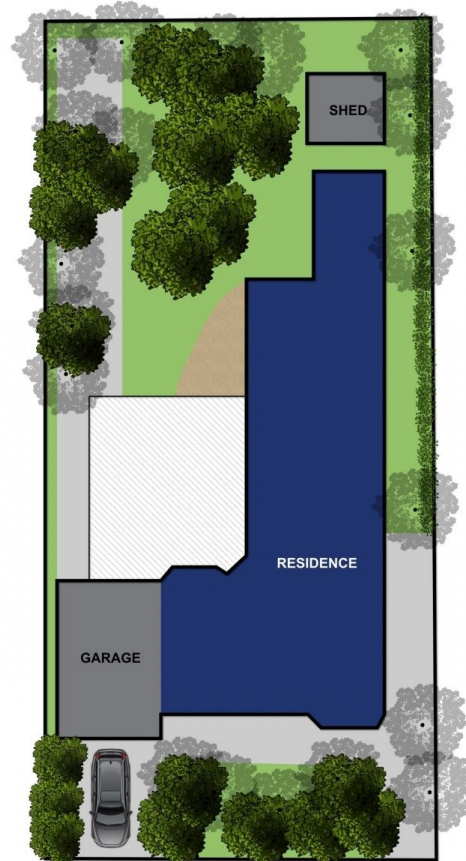

Whilst [bwrn.com.au](http://bwrn.com.au) has made every attempt to ensure the accuracy of the floor plan contained here, measurements are approximate and no responsibility is taken for any error, omission, or mis-statement. This plan is for illustrative purposes only.

## 10 HAMPDEN CLOSE, BARWON HEADS

bellarineproperty