



13 Glyndon Court Barwon Heads VIC

3 2 3

A perfect orientation, lush leafy gardens and a picturesque rural aspect, come together to produce a tranquil indoor/outdoor lifestyle rarely achieved but commonly envied. Alfresco living is a highlight for this custom built, north facing entertainer, ideally situated in the highly desirable and family orientated river-end precinct.

- Fantastic open plan living, meals and kitchen area seamlessly flowing to the outdoors
- Beautiful rural vista to the rear of the property, harnessing the warmth of evening sunsets
- Multiple outdoor entertaining spaces, highlighting the importance of alfresco living
- Privatised on all sides by established, carefully curated gardens and mature trees
- Elevated, raked ceilings amplify the sense of space immediately upon entry
- Modern entertainers kitchen with large island bench and a wealth of storage options
- Brand new Stainless Steel appliances and a large corner pantry complete this industrious space
- A separately zoned bedroom wing is ideally placed away from the busy nucleus

Price : \$ 850,000
Land Size : 725 sqm
View : <https://www.bellarineproperty.com.au/3770347>



Levi Turner
03 5254 3100



Peta Walter
03 5254 3100

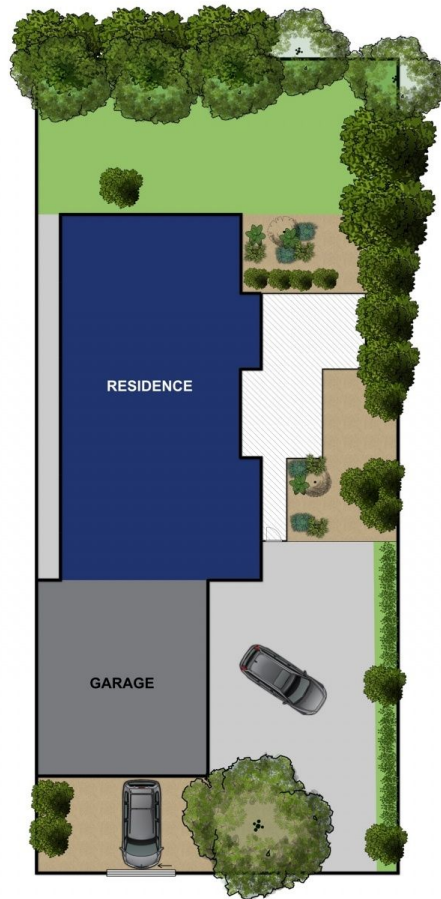

Approx Area 293.2m²

Whilst bwrn.com.au has made every attempt to ensure the accuracy of the floor plan contained here, measurements are approximate and no responsibility is taken for any error, omission, or mis-statement. This plan is for illustrative purposes only.



13 GLYNDON COURT, BARWON HEADS

bellarineproperty