



33 Norman Crescent Point Lonsdale VIC

3 2 2

Prestigiously set in a little known court, boasting direct access to the Point Lonsdale Golf Course and stunning treed outlooks across the 10th Fairway, this wonderfully versatile three bedroom home offers you an unparalleled leisure based lifestyle. North facing and slightly elevated, glimpses of Lake Victoria and the immaculately kept golf course surrounds will be a constant reminder of just how you lucky you have become.

- One of only a few established properties in this area, boasting direct golf course access
- Stunning outlooks through ample glazing of the beautifully landscaped environment
- Running alongside the picturesque 10th Fairway and onto the 11th Tee
- The north facing front yard is privatised from the street by beautiful, mature native trees
- Uninterrupted views of Lake Victoria could be achieved with a second level (STCA)
- Fantastic split zoned living spaces, allowing multiple usage and perfect for growing families
- Raked ceilings amplify the interior footprint, gifting more space and light throughout

Price : \$ 851,000
Land Size : 660 sqm
View : <https://www.bellarineproperty.com.au/37416>
 86



Lee Martin
 03 5297 3888



Dan Halsey
 03 5254 3100

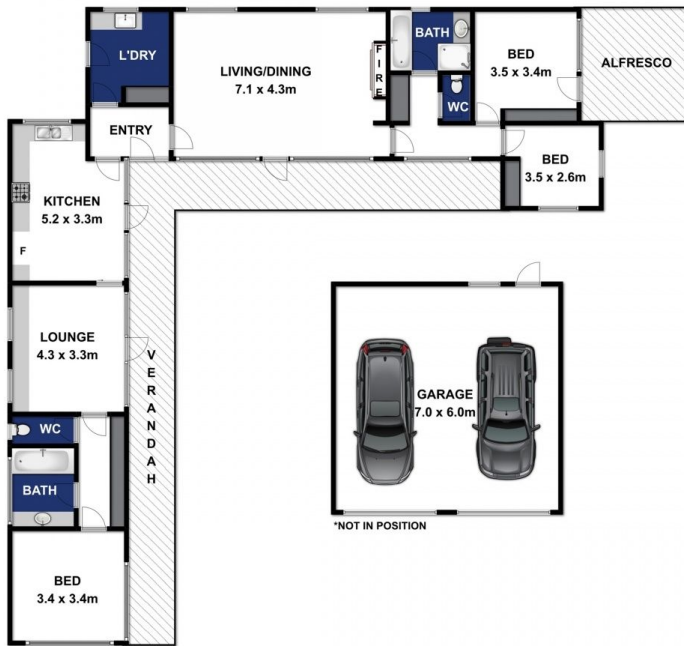

Approx Area 233.8m²

Whilst bwrn.com.au has made every attempt to ensure the accuracy of the floor plan contained here, measurements are approximate and no responsibility is taken for any error, omission, or mis-statement. This plan is for illustrative purposes only.



33 NORMAN CRESCENT, POINT LONSDALE

bellarineproperty