



12 Lakes Entrance Point Lonsdale VIC

4 2 2

This 4-bedroom home in 'The Point' delivers breathtaking wow factor. The first step indoors exceeds all expectations. Soaring ceilings and highlight glazing deliver the big architectural assets of space and light, and the open floorplan, zoned into functionable family-orientated spaces, boosts the appeal. If you're after architecturally inspired coastal living in a contemporary, leisure-based setting, please step this way!

- Nestling gardens boost ambiance in all rooms, increasing privacy and relaxation
- Double glazed windows have thermal and acoustic benefits
- Children will enjoy their independence in the minor bedroom wing at the facade
- The master suite is shrouded in privacy at the rear with garden accesses
- The central living hub is exceptional - a great space to share family time
- Large zones for cooking, dining and relaxation have calm, leafy, green outlooks
- Caesarstone, opalescent glass splashback and 90cm apps are stylish kitchen assets

Price : \$ 803,000
Land Size : 536 sqm
View : <https://www.bellarineproperty.com.au/33373>
 10



Lee Martin
 03 5297 3888



Christian Bartley
 03 5254 3100

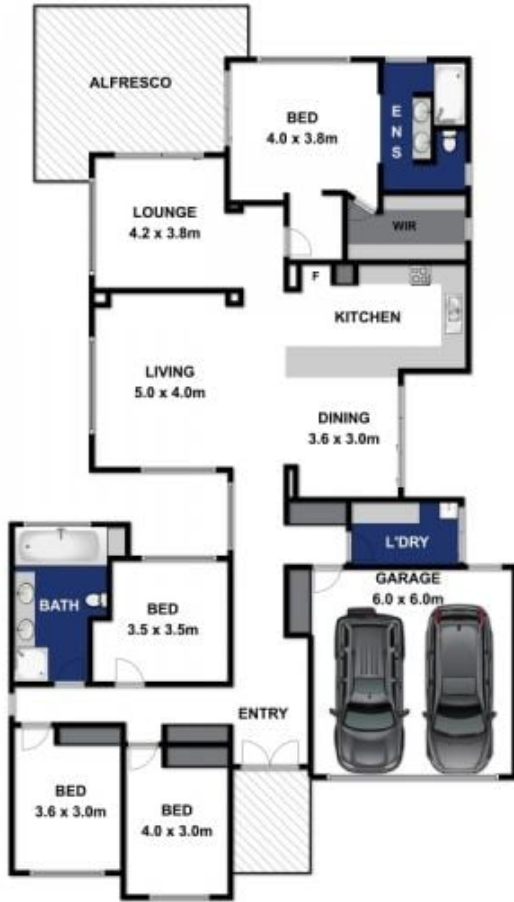

Approx Area 235.4m²

Whilst bwm.com.au has made every attempt to ensure the accuracy of the floor plan contained here, measurements are approximate and no responsibility is taken for any error, omission, or mis-statement. This plan is for illustrative purposes only.

12 LAKES ENTRANCE, POINT LONSDALE

bellarineproperty