



1/86-88 Christies Road Leopold VIC

2 2 1

This exciting new development consists of 7 well appointed and contemporary styled townhouses which all house two bedrooms, two bathrooms and a single garage.

Price : \$ 325,000
View : <https://www.bellarineproperty.com.au/3224325>

Constructed by the highly renowned Ocean Breeze Homes, you are ensured second to none finishes and fixtures throughout your new home.



Toby Lee
03 5254 3100

Centrally located in the heart of thriving Leopold, close to schools, public transport, shopping centres, and only 15mins Geelong!! Leopold is known as the "Gateway" to the beautiful Bellarine Peninsula and it is one of the largest established communities on the Bellarine, so long term investment for the future is a certainty.

All of these townhouses offer open plan living, alfresco areas, private courtyards and are fully landscaped for an incredible turn-key package. Take the worry out of building or renovating, have it all managed for you.

The stylish and well thought-out plan ensures all townhouses are easily accessible and allow total privacy from the neighbours. The spacious kitchens feature stone

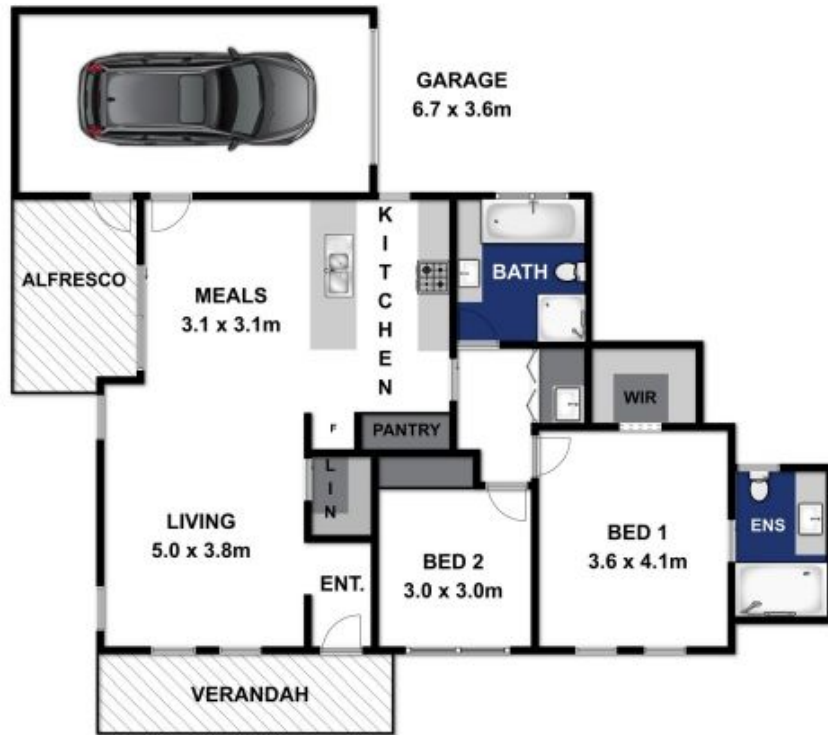

Whilst bwrn.com.au has made every attempt to ensure the accuracy of the floor plan contained here, measurements are approximate and no responsibility is taken for any error, omission, or mis-statement. This plan is for illustrative purposes only.



1 / 86-88 CHRISTIES ROAD, LEOPOLD

bellarineproperty