



1/52 Penleigh Crescent Ocean Grove VIC

3 2 2

A great options for downsizers or first home owners, this modern townhouse is located in a quiet crescent that culminates at the lake and parkland, with The Market Place shopping centre and schools within walking distance. From here, enjoy a very convenient and attractive lifestyle! Absolutely ideal for investors!

Price : \$ 416,500
Land Size : 328 sqm
View : <https://www.bellarineproperty.com.au/31929>
 49

- Smart facade calls on a contemporary blend of dark and light brick and raked roofline
- Interiors feature quality tiling and carpet
- Neutral palette promises to age with grace
- Stainless steel apps to kitchen include Asko dishwasher
- Open plan living/dining is comfortable for entertaining
- Indoor-outdoor flow to low-maintenance courtyard
- Garden caters beautifully to quiet contemplation
- Master bed with WIR and neat en suite
- 2 minor beds with BIRs
- SS-AC, 2000L water tank plumbed to toilets,
- Drive-through DLUG provides additional secure parking for a pop-top caravan, vehicle or trailer.

This home really is the perfect downsizer's base, with room to cater for friends and family- or an easy investment with



Toby Lee
 03 5254 3100

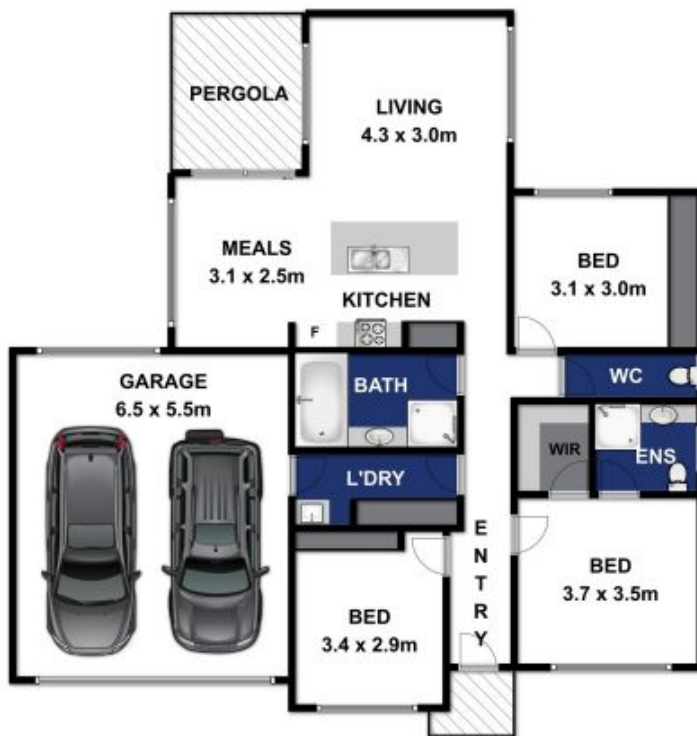

Whilst bwrn.com.au has made every attempt to ensure the accuracy of the floor plan contained here, measurements are approximate and no responsibility is taken for any error, omission, or mis-statement. This plan is for illustrative purposes only.



1/52 PENLEIGH CRESCENT, OCEAN GROVE

bellarineproperty