



## 12 Wattlebird Crescent Barwon Heads VIC

4 2 2

Set on a large corner allotment with lush garden surrounds, this home delivers huge tranquility as well as enviable indoor-outdoor living and entertaining spaces. Brimming with privacy and space and completely free from over lookers, the home's open plan design maximises the garden outlook. This secluded family retreat is just 200m from the river and boat ramp!

- The home offers 4 bedrooms and 2 living areas - idyllic spaces for a family to grow
- Immaculate presentation and soft coastal decor is pleasing on entry
- The nestling garden has a calming effect in the lounge and master bedroom
- Enjoy the quietness of the lounge, zoned away from the busy living hub
- The master, with roomy built-in robes and fresh en suite, also offers private rejuvenation
- The central living hub is a considerable space complete with large family kitchen and lovely light
- Large glass sliders in the dining and living areas dissolve the boundaries between indoors and out
- Living boasts split system AC and built-in audio-visual

**Price** : \$ 745,000  
**Land Size** : 771 sqm  
**View** : <https://www.bellarineproperty.com.au/2281327>



**Levi Turner**  
**03 5254 3100**

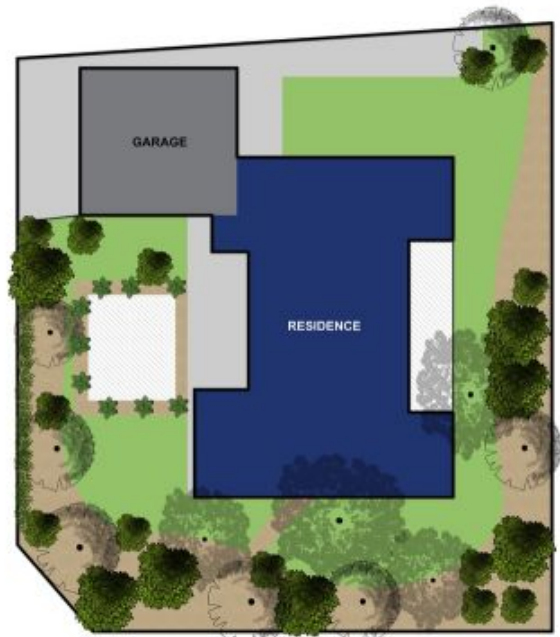

**12 WATTLE BIRD CRESCENT, BARWON HEADS**

Whilst every attempt has been made to ensure the accuracy of the floor plan contained here, measurements of doors, windows, rooms and any other items are approximate and no responsibility is taken for any error, omission, or mis-statement. This plan is for illustrative purposes only and should be used as such by any prospective purchaser. The services, systems and appliances shown have not been tested and no guarantee as to their operability or efficiency can be given.