



67 Endeavour Drive Ocean Grove VIC

3 2 2

Open the front door and be greeted by stunning views of the Point Lonsdale lighthouse. This calm, 3 bedroom home is brimming with unique character, and enhanced by a breathtaking coastal panorama across Collendina valley. Convenient to the Surfside Hub, shops and beach, yet unaffected by suburbia, this home feels like a permanent summer holiday!

Price : \$ 590,000
Land Size : 561 sqm
View : <https://www.bellarineproperty.com.au/2213669>

- The 2-storey design follows the lay of the land, with lofty private outlook capitalising on the view
- The floor plan is filled with natural light, with an immaculate finish throughout
- Open plan living, 2 bedrooms and 2 bathrooms upstairs
- A 3rd bedroom, fabulous rumpus space, laundry and toilet downstairs
- Entry is through the perfectly private and sundrenched northern courtyard
- Proportioned for BBQs and entertaining this protected space is effectively a 3rd living zone
- Views are spectacular on entry, the lighthouse front and centre!
- The lengthy dune line dips, revealing activity in the shipping lane



Toby Lee
03 5254 3100



Dan Halsey
03 5254 3100

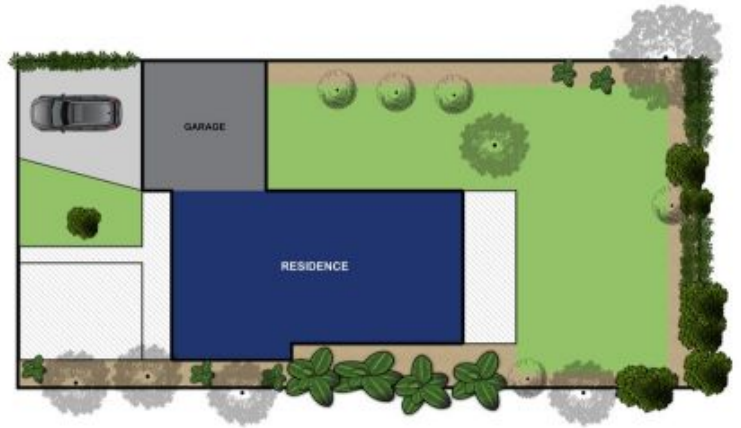

67 ENDEAVOUR DRIVE, OCEAN GROVE

Whilst every attempt has been made to ensure the accuracy of the floor plan contained here, measurements of doors, windows, rooms and any other items are approximate and no responsibility is taken for any error, omission, or mis-statement. This plan is for illustrative purposes only and should be used as such by any prospective purchaser. The services, systems and appliances shown have not been tested and no guarantee as to their operability or efficiency can be given.