



2/16 Jasper Avenue Barwon Heads VIC

2 2 1

This neat, north facing townhouse is private, affordable and low maintenance. Positioned within walking distance to everything Barwon Heads has to offer, this new build offers so much to offer. This townhouses represent excellent value and is the cheapest townhouse for sale in 'old' Barwon Heads. You won't see prices like this again!

- offering two bedrooms and two bathrooms
- open plan living on the ground level
- north facing private decked entertaining area with outlook & accommodating outdoor/indoor entertaining
- kitchen with Caesarstone bench top, soft closed drawers, window splash backs and Bosch appliances
- extras including electric oven, induction cook top, range hood, microwave and dishwasher
- Upstairs consists of two bedrooms and two bathrooms
- bedrooms comprise of vaulted ceilings, built in robes, carpet and private balcony access
- bathrooms showcase modern unique fixtures in neutral tones
- additions include strengthened glazing, new generation solar systems for self sufficiency, low voltage lighting, a 2100 litre tanks for recycled water and irrigation reverse

Price : \$ 537,000

View : <https://www.bellarineproperty.com.au/2133077>



Christian Bartley
03 5254 3100



Levi Turner
03 5254 3100

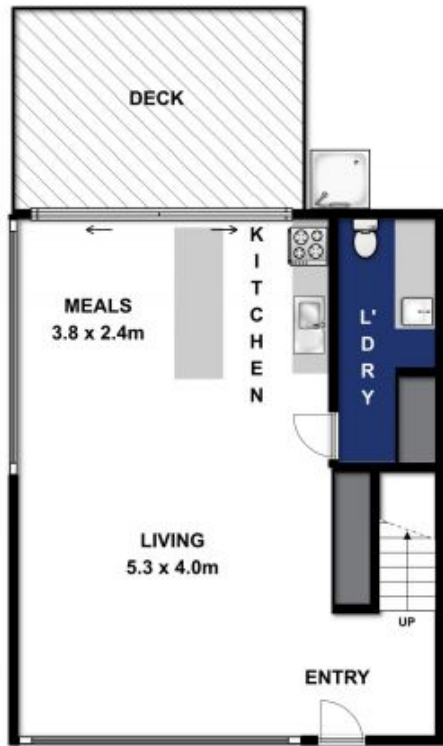

GROUND FLOOR

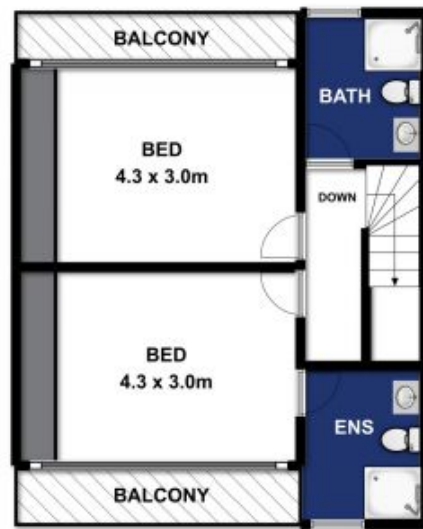

FIRST FLOOR

2/16 JASPER AVENUE, BARWON HEADS

Whilst every attempt has been made to ensure the accuracy of the floor plan contained here, measurements of doors, windows, rooms and any other items are approximate and no responsibility is taken for any error, omission, or mis-statement. This plan is for illustrative purposes only and should be used as such by any prospective purchaser. The services, systems and appliances shown have not been tested and no guarantee as to their operability or efficiency can be given.



JASPER AVENUE & PUNT ROAD, BARWON HEADS

Whilst every attempt has been made to ensure the accuracy of the floor plan contained here, measurements of doors, windows, rooms and any other items are approximate and no responsibility is taken for any error, omission, or mis-statement. This plan is for illustrative purposes only and should be used as such by any prospective purchaser. The services, systems and appliances shown have not been tested and no guarantee as to their operability or efficiency can be given.