



### 18 Northcote Road Ocean Grove VIC

3 2 2

This quality home is built for relaxing whether it be perched on the top level enjoying ocean views or nearer to ground floor amongst your own oasis like gardens there is a perfect place for every moment.

Split across 3 levels to maximise the view and sloping plot, the open plan living is placed at the highest level to take in the view from wall to wall glazing. A completely enclosed, carpeted verandah stretched across the rear enhances views further, a space dedicated to sitting, watching the ships roll in, (complete with its own wall mounted heater). Climate control is offered by ducted gas heating & large RC SS.

The appealing contemporary kitchen is a functional and stylish space. Chef wall oven and wide gas hob offer quality, and sleek handle-less neutral coloured cabinetry includes a full wall of floor to ceiling pantry in addition to a U section of underbench and overhead cabinets.

Beautiful slate tiling runs through high traffic areas on each level while carpeted stairs and timber doors and trims continue the timeless quality of the brick and tile home. Upon ground level is bedroom 3 and laundry, while the lower ground floor holds bedroom 2, central bathroom and master suite. The bright bathroom offers fully recessed

**Price** : \$ 490,000  
**Land Size** : 585 sqm  
**View** : <https://www.bellarineproperty.com.au/18467>  
50



**Toby Lee**  
03 5254 3100



**Dan Halsey**  
03 5254 3100

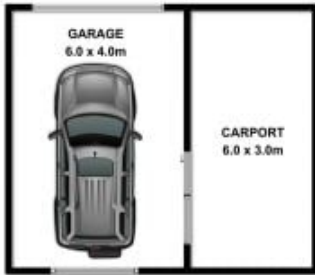

**GROUND**

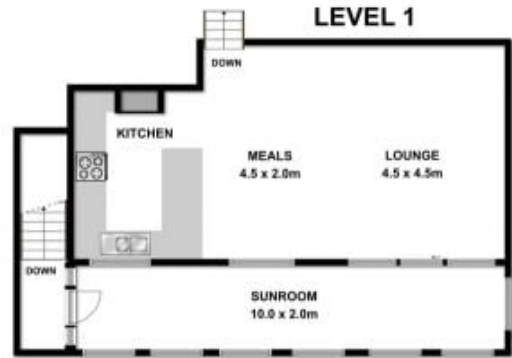

**18 NORTHCOTE ROAD, OCEAN GROVE**

Whilst every attempt has been made to ensure the accuracy of the floor plan contained here, measurements of doors, windows, rooms and any other items are approximate and no responsibility is taken for any error, omission, or mis-statement. This plan is for illustrative purposes only and should be used as such by any prospective purchaser. The services, systems and appliances shown have not been tested and no guarantee as to their operability or efficiency can be given.