



54 Endeavour Drive Ocean Grove VIC

3 2 2

Floating above it all at the edge of town, this elevated contemporary coastal home gives a feeling of peace and solitude with uninterrupted outlook of rural and coastal vistas.

- The modern coastal design emphasises outdoor living amongst breathtaking views
- Built across 2 levels on an elevated plot, inside living is filled with evergreen & ocean scenery
- Views stretch across canola fields to Pt Lonsdale Lighthouse, The Rip & Bass Strait
- A peaceful location just 20 min walk to beaches with shops and recreation spaces nearby
- Curved rooftops and walls of glass create an organic theme mimicking the natural surrounds
- Endless glazing lines the entire south east aspect on each level affording imposing panorama
- Deep decking with glass balustrade extends from both stories offering sheltered spaces to relax
- Light filled rooms on ground level include a large living with wet bar & 2 queen sized bedrooms
- Family bathroom & laundry on this level offer easy rear yard access - great after beach visits

Price : \$ 675,000
Land Size : 581 sqm
View : <https://www.bellarineproperty.com.au/17498>
 10



Dan Halsey
 03 5254 3100

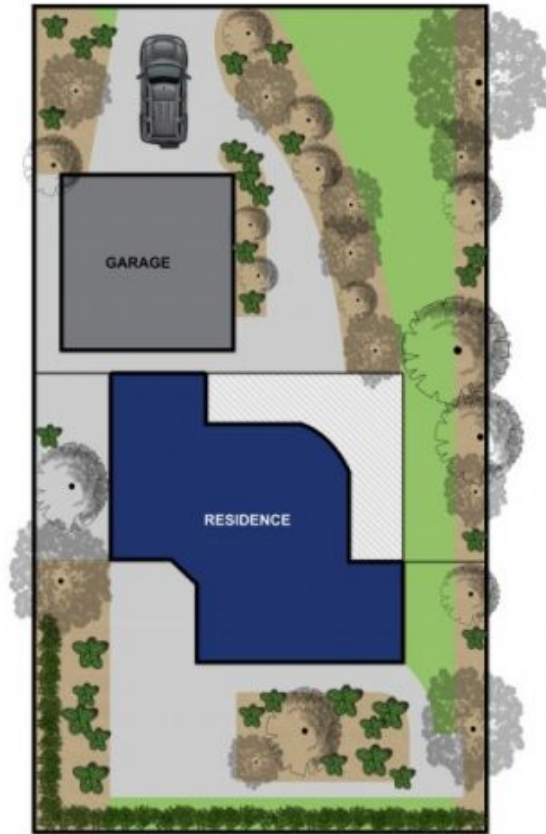

54 ENDEAVOUR DRIVE, OCEAN GROVE

Whilst every attempt has been made to ensure the accuracy of the floor plan contained here, measurements of doors, windows, rooms and any other items are approximate and no responsibility is taken for any error, omission, or mis-statement. This plan is for illustrative purposes only and should be used as such by any prospective purchaser. The services, systems and appliances shown have not been tested and no guarantee as to their operability or efficiency can be given.