

## 9 Mermaid Avenue OCEAN GROVE VIC

6 4 3

Ocean, estuary and bluff views are truly welcomed into this home. Split across five levels to accommodate the largest of families as well as ensure views from almost every space, each member of the family will enjoy sunsets, water or treetop views in the comfort of their own private space.

- Three split levels of extensive, flexible family living capitalise on wide spread coastal views
- Modern cubic styled facade incorporates rendered walls, large windows and glass balustrading
- Up to 6 bedrooms allow large family accommodation in a generous and private split level design
- Extensive glazing within living spaces let the views impose on everyday life
- Ground floor accommodates four bedrooms, two bathrooms and vehicle storage
- One lower floor bedroom offers rear yard access to easily convert to living space
- Second storey consists of split level living, (2 zoned spaces), kitchen, dining and master suite
- Central open plan living allows the views to be enjoyed from kitchen and dining
- Kitchen with modern finishes includes gloss cabinetry,

**Land Size** : 590 sqm

**View** : <https://www.bellarineproperty.com.au/1503470>



**Christian Bartley**  
03 5254 3100



**Dan Halsey**  
03 5254 3100



**LEVEL 5**



**LEVEL 3 & LEVEL 4**



**LEVEL 1 & LEVEL 2**

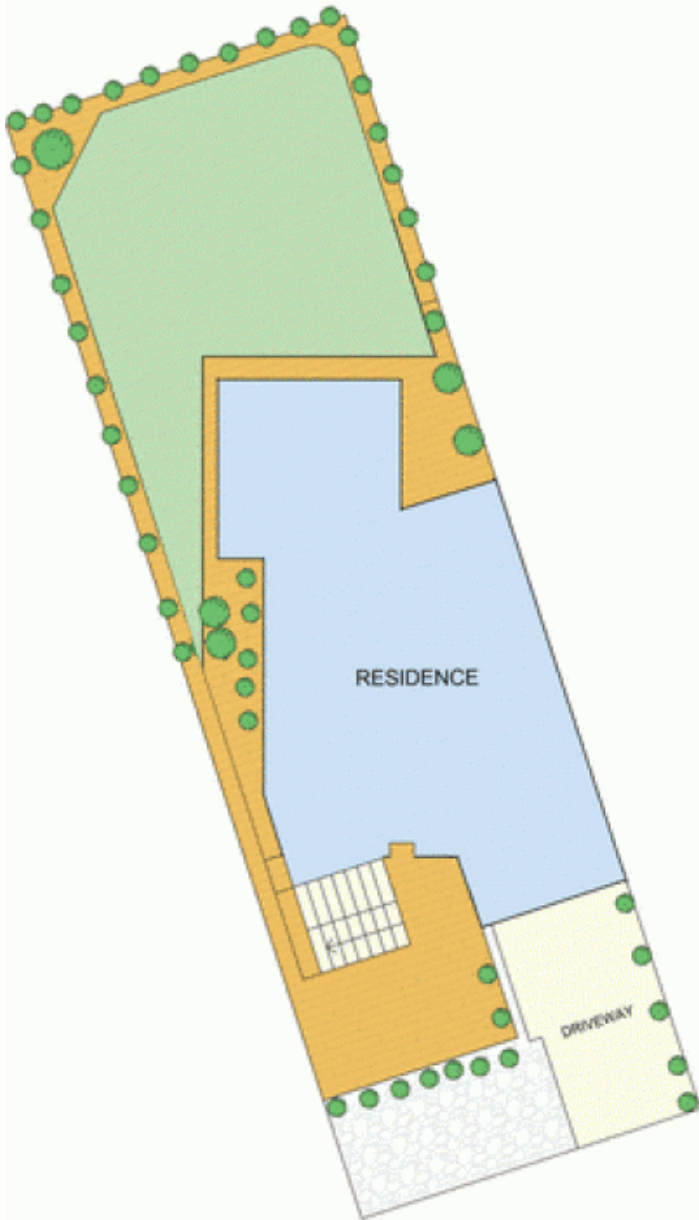

NB: Land size and dimensions are approximate.

NOTE: Every precaution has been taken to verify the accuracy of the above details. However, prospective purchasers are advised to make their own enquiries. Fletchers gives no warranty to the above and expressly disclaims all liability for any loss or damage, whatever the cause which may arise from any person acting on any such statements.