



20A Roebourne Street OCEAN GROVE VIC

3 2 2

This sparkling new townhouse features all the mod cons and more in a private seaside location.

- North facing windows allow flowing natural light
- The immaculate presentation is a reminder you will be the first resident
- Open plan living enjoys neutral decor
- North-facing garden and courtyard
- Double lock up garage with remote
- 2000 litre water tank
- Split system heating and cooling
- 6 star energy rating
- Fully landscaped

Price : \$ 360,000

View : <https://www.bellarineproperty.com.au/1503381>



Dan Halsey
03 5254 3100

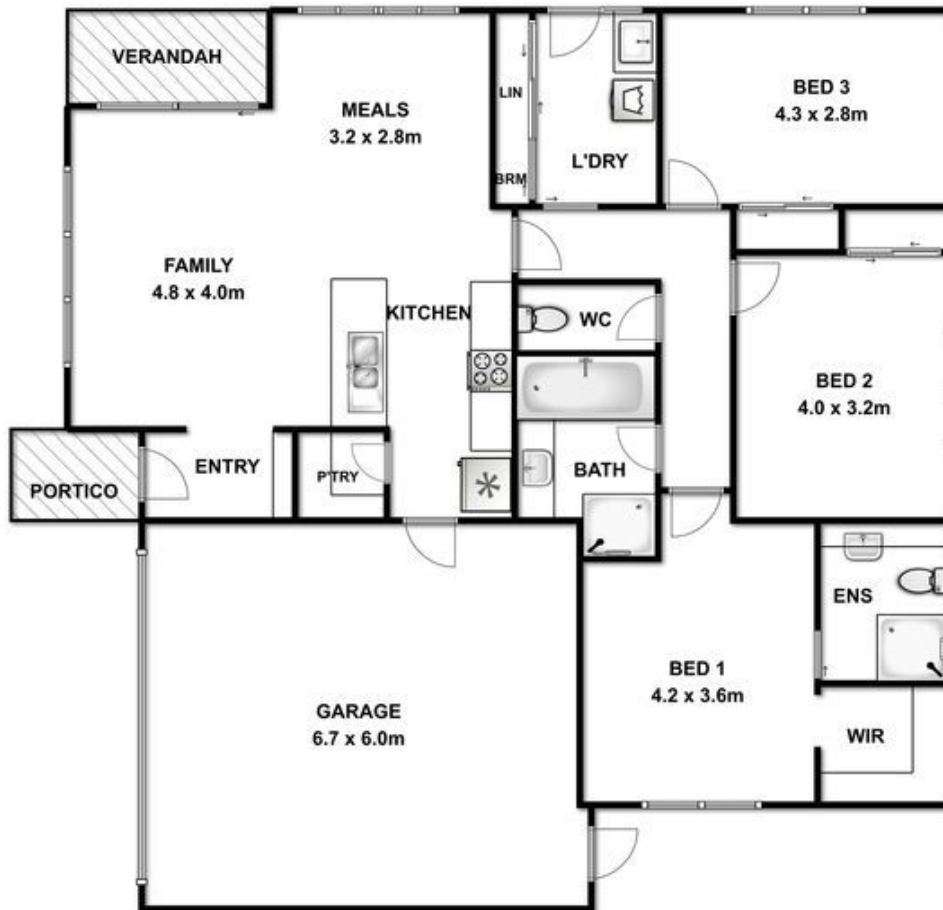

Whilst every attempt has been made to ensure the accuracy of the floor plan contained here, measurements of doors, windows, rooms and any other items are approximate and no responsibility is taken for any error, omission, or mis-statement. This plan is for illustrative purposes only and should be used as such by any prospective purchaser. The services, systems and appliances shown have not been tested and no guarantee as to their operability or efficiency can be given.